



# **Spadina Station (Line 1) Easier Access Program Update**

## **Public Presentation**

November 2024

# | Easier Access Program



- TTC's Advisory Committee on Accessible Transit (ACAT) has a critical role in making TTC accessible.
- Comprised of volunteers, ACAT helps TTC design and implement the Easier Access Programs through the lens of persons with disabilities and seniors.
- 54 of 70 subway stations are now accessible.
- By the end of 2025, 66 of 70 stations are scheduled to be accessible, taking us to 94%.
- Easier access work continues at the following stations:
  - **Spadina**, Donlands, Castle Frank, Glencairn, Summerhill, Rosedale, Greenwood, High Park, Lawrence, College, Christie, Museum, Warden, Islington, and King.

# | Spadina Station Easier Access

## Easier Access Improvements

Barrier-free path between Line 1 platform and the underground pedestrian walkway, which leads to Spadina Station Line 2, the streetcar platform, the bus terminal and the street-level entrances/exits.

- Two new elevators.
- PRESTO-enabled accessible fare gates (installed).
- Improved signage.
- CCTV – Security cameras inside of the station.

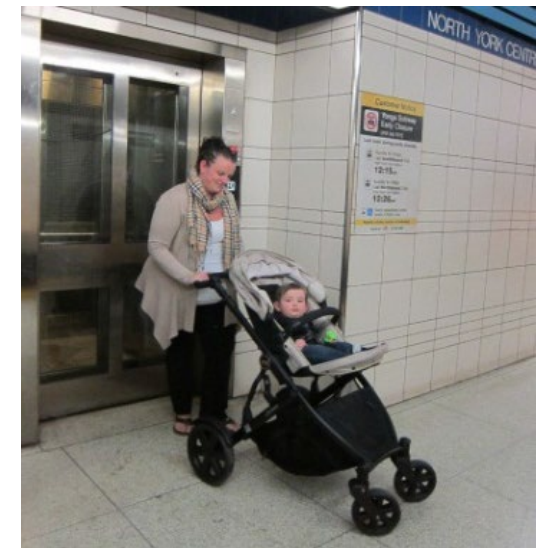



# Project Site

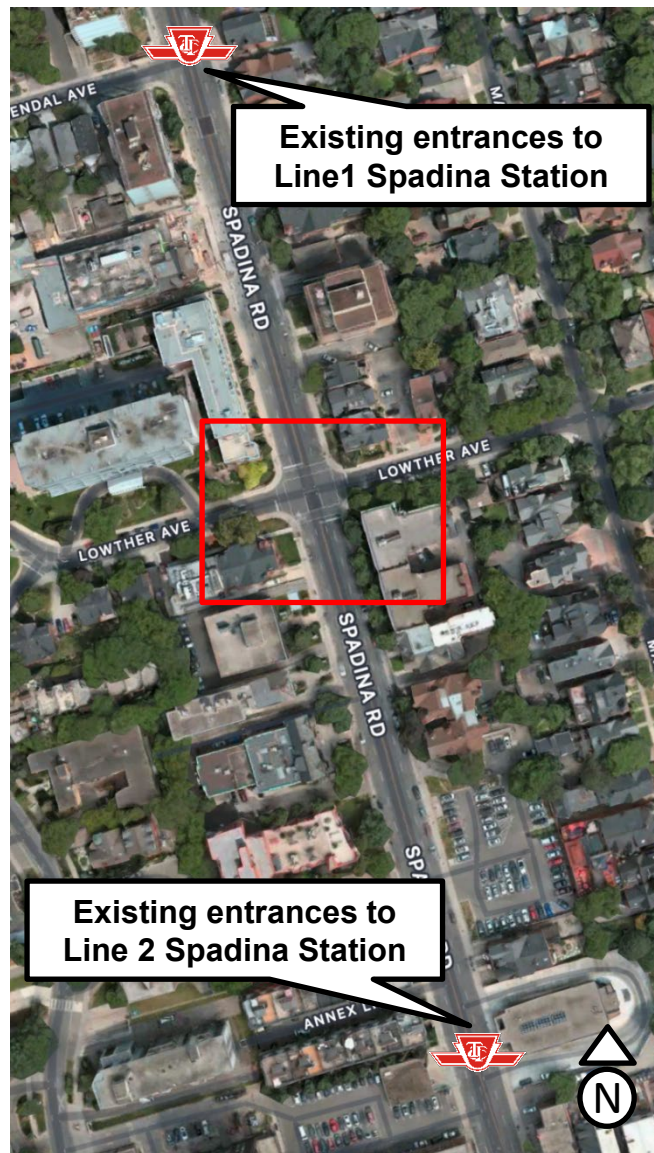



# Spadina Station Elevation Plan

## 2 Spadina Station (Bloor-Danforth)

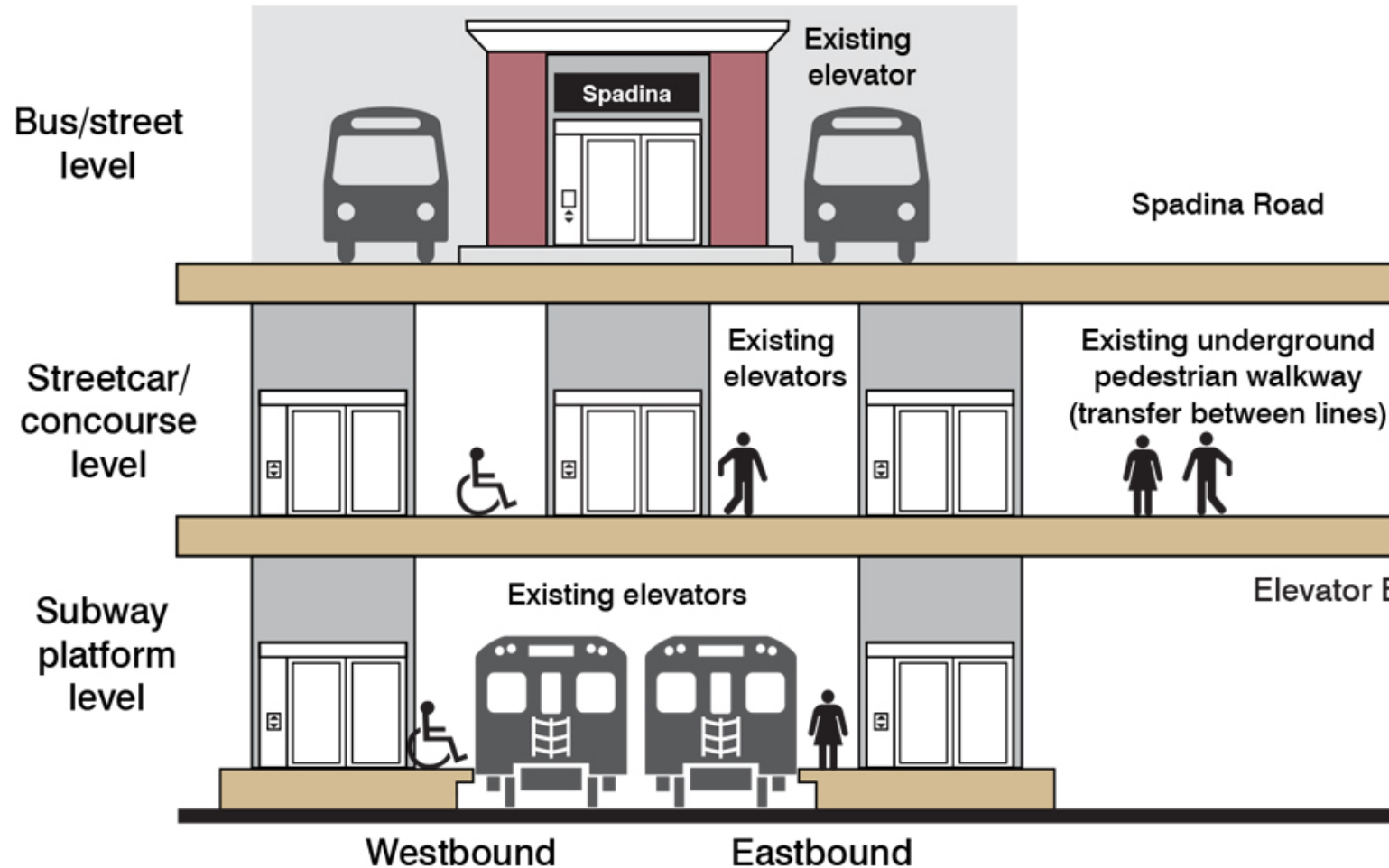

**No elevator structure or entrance at street level for Spadina Station Easier Access**

## 1 Spadina Station (Yonge-University)

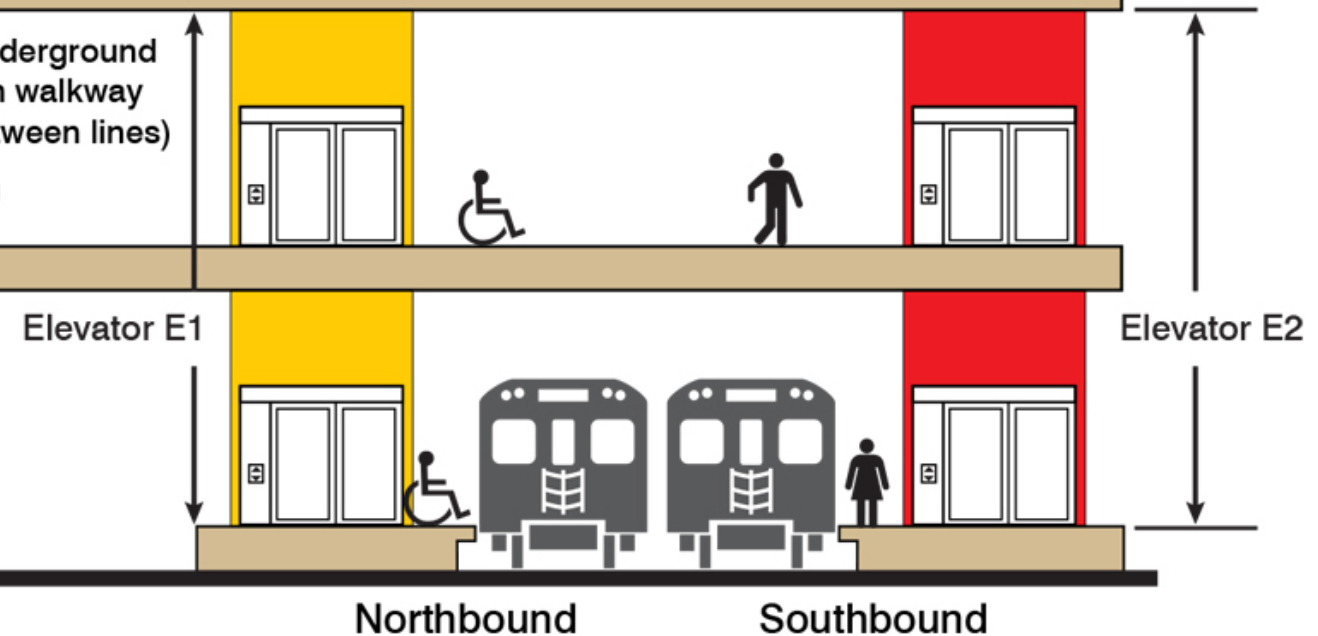

# Concourse Level

## Existing

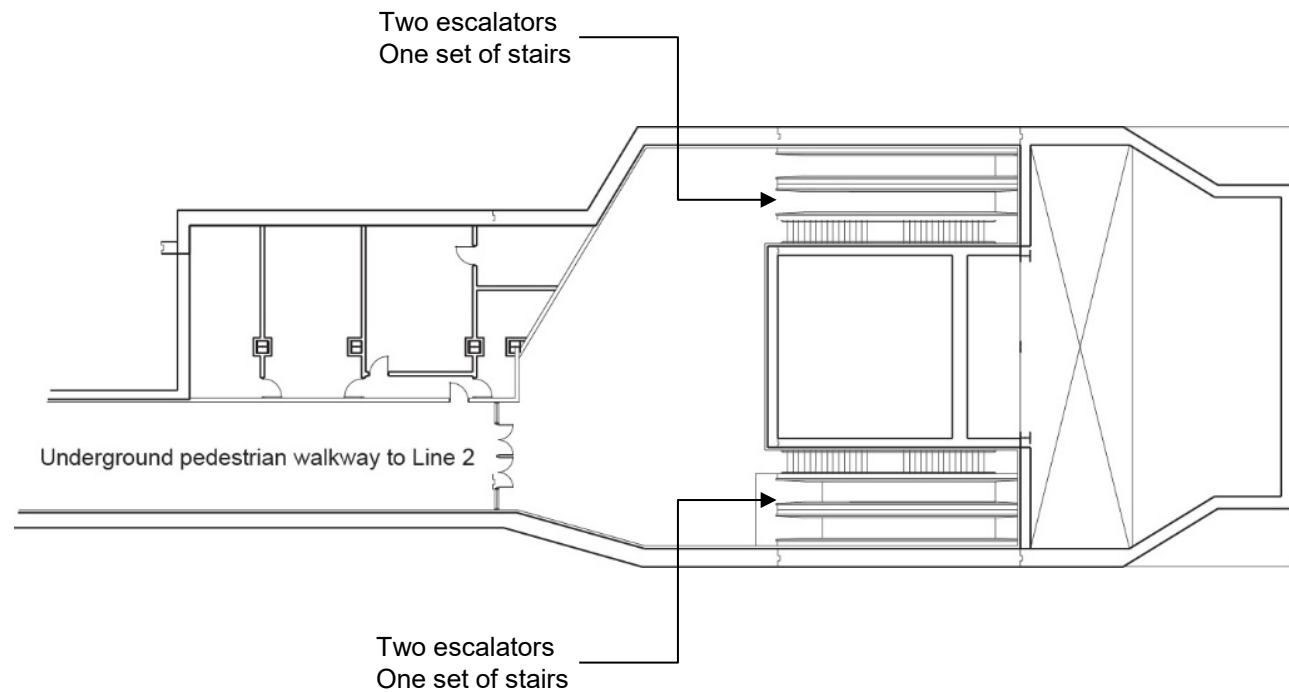

## Post-construction

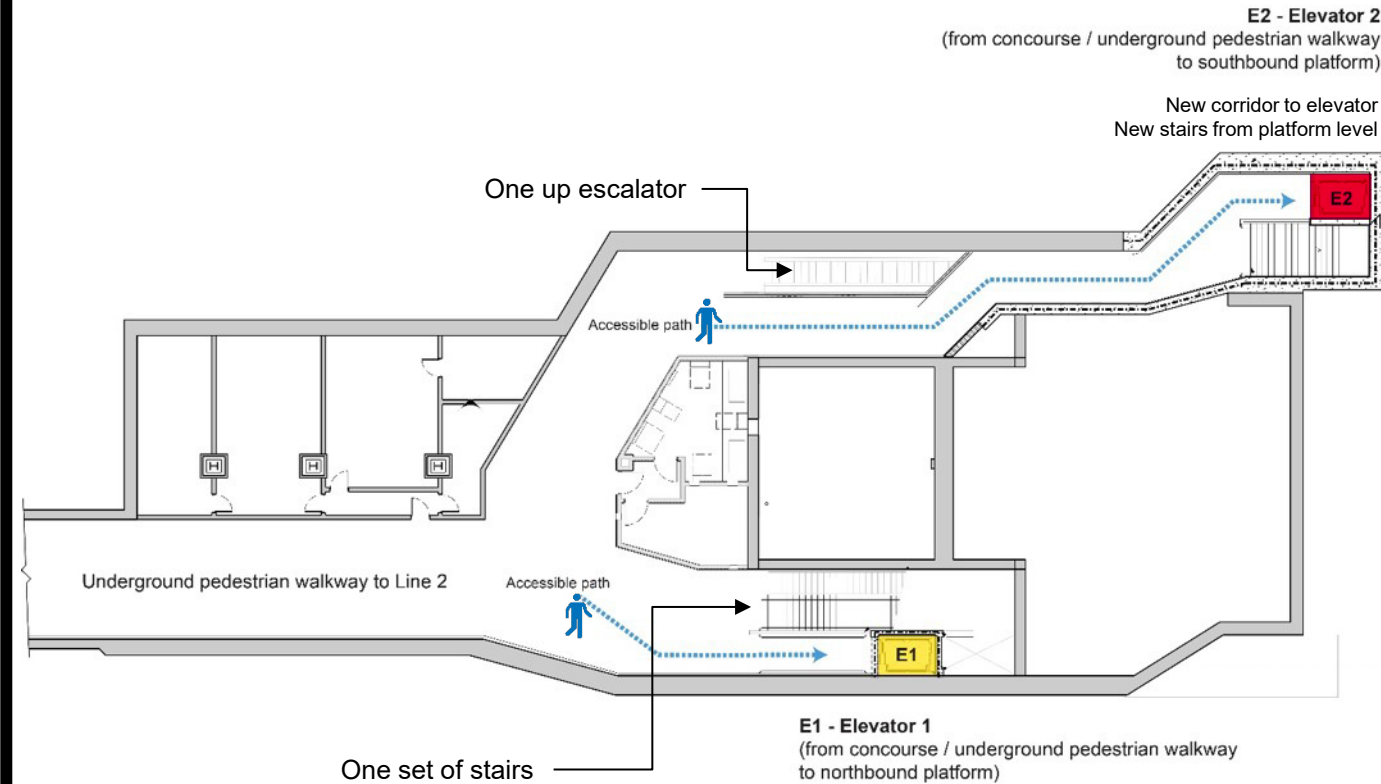

*\*To accommodate new elevator construction, 3 of 4 escalators are being removed permanently. One escalator will remain from the southbound platform.*



# | Existing Subway Platform Level

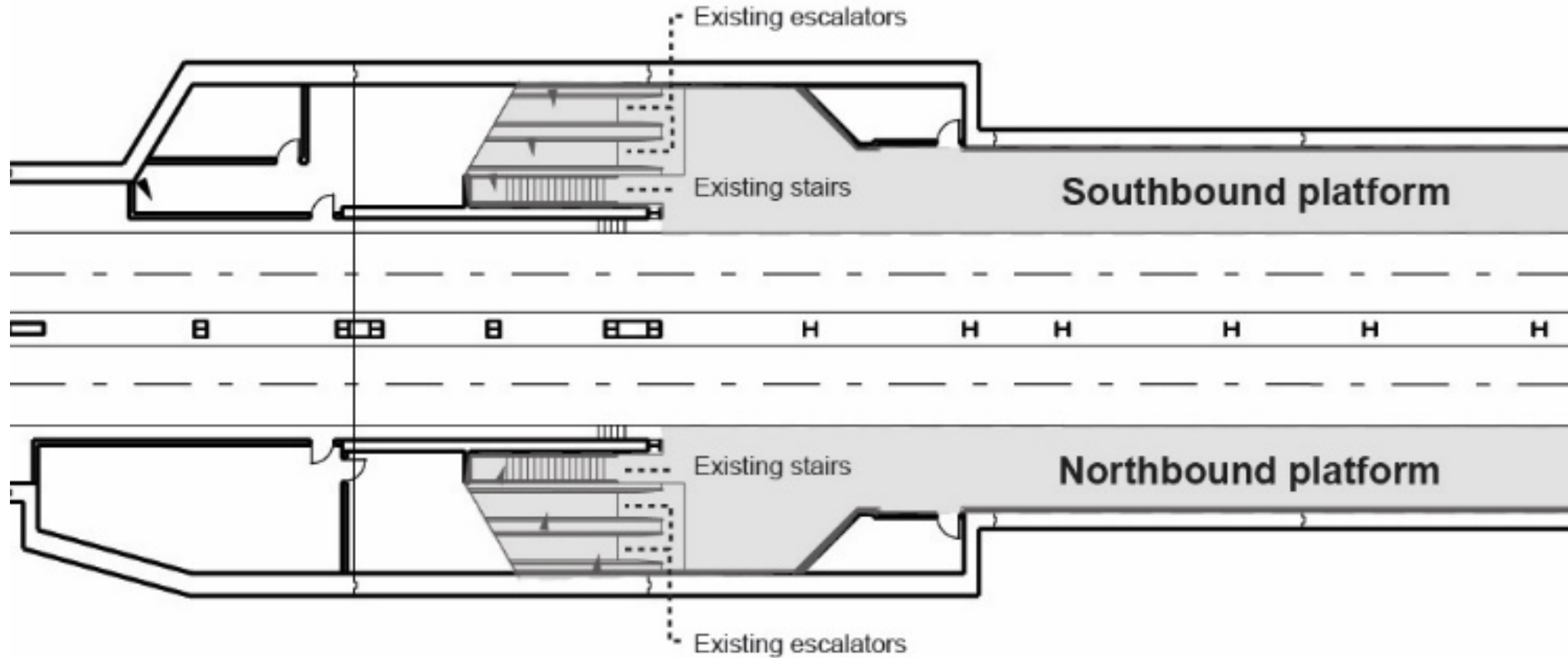

# New Subway Platform Level with New Elevators

*\*To accommodate new elevator construction, 3 of 4 escalators are being removed permanently. One escalator will remain from the southbound platform.*

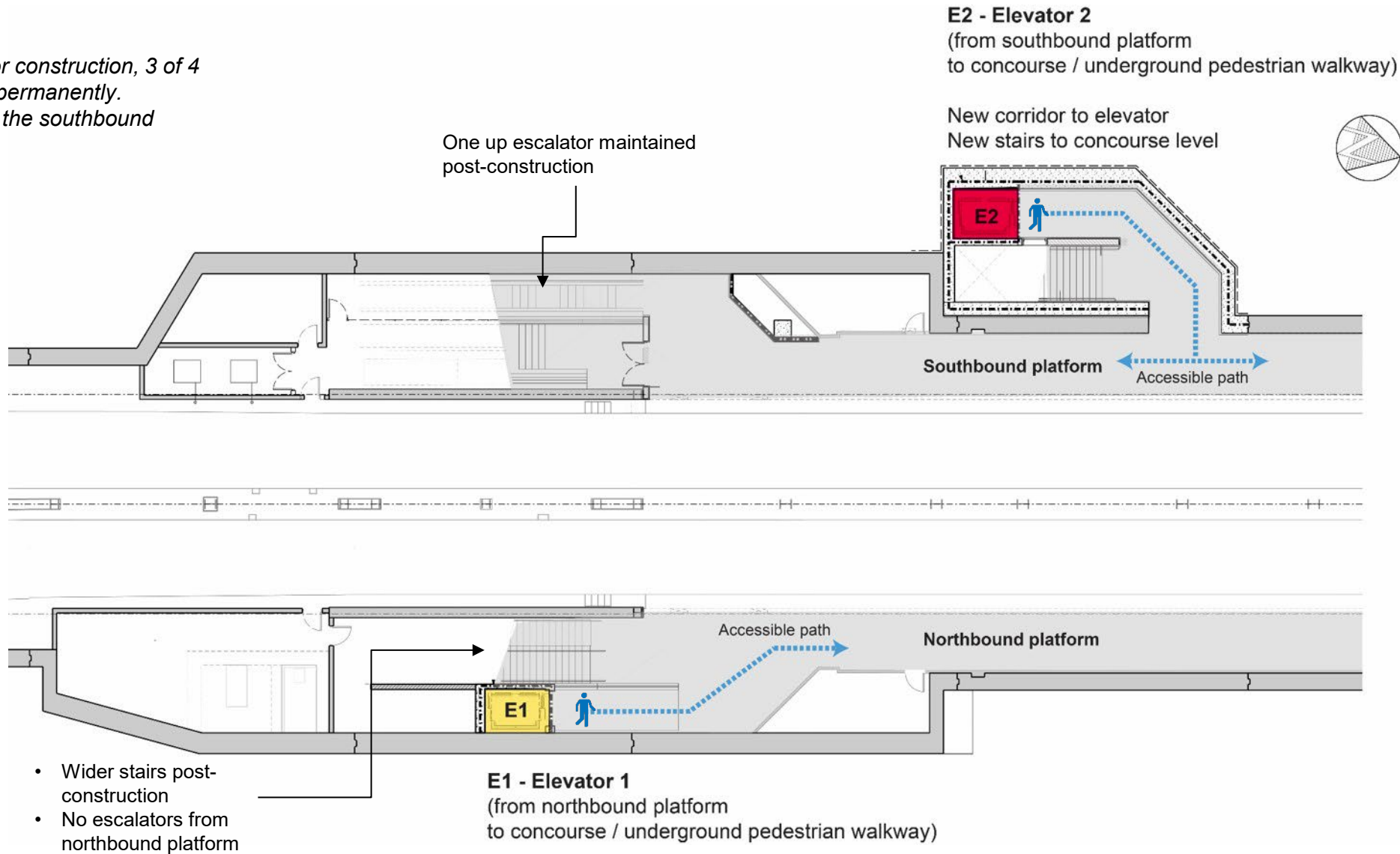



# Phases and Staging

- Construction is focused at Spadina Rd and Lowther Ave.
- Work to be completed in two phases:
  - Phase 1: Utility relocations west of Spadina Rd will be completed first, followed by construction of elevator 2 (E2) west of Spadina Rd. Once construction west of Spadina Rd is complete, the area will be restored.
  - Phase 2: Construction of elevator 1 (E1) east of Spadina Rd will be completed and the area will be restored.
- During both phases:
  - Street-level construction and work inside the station.
  - Internal and external coordination.

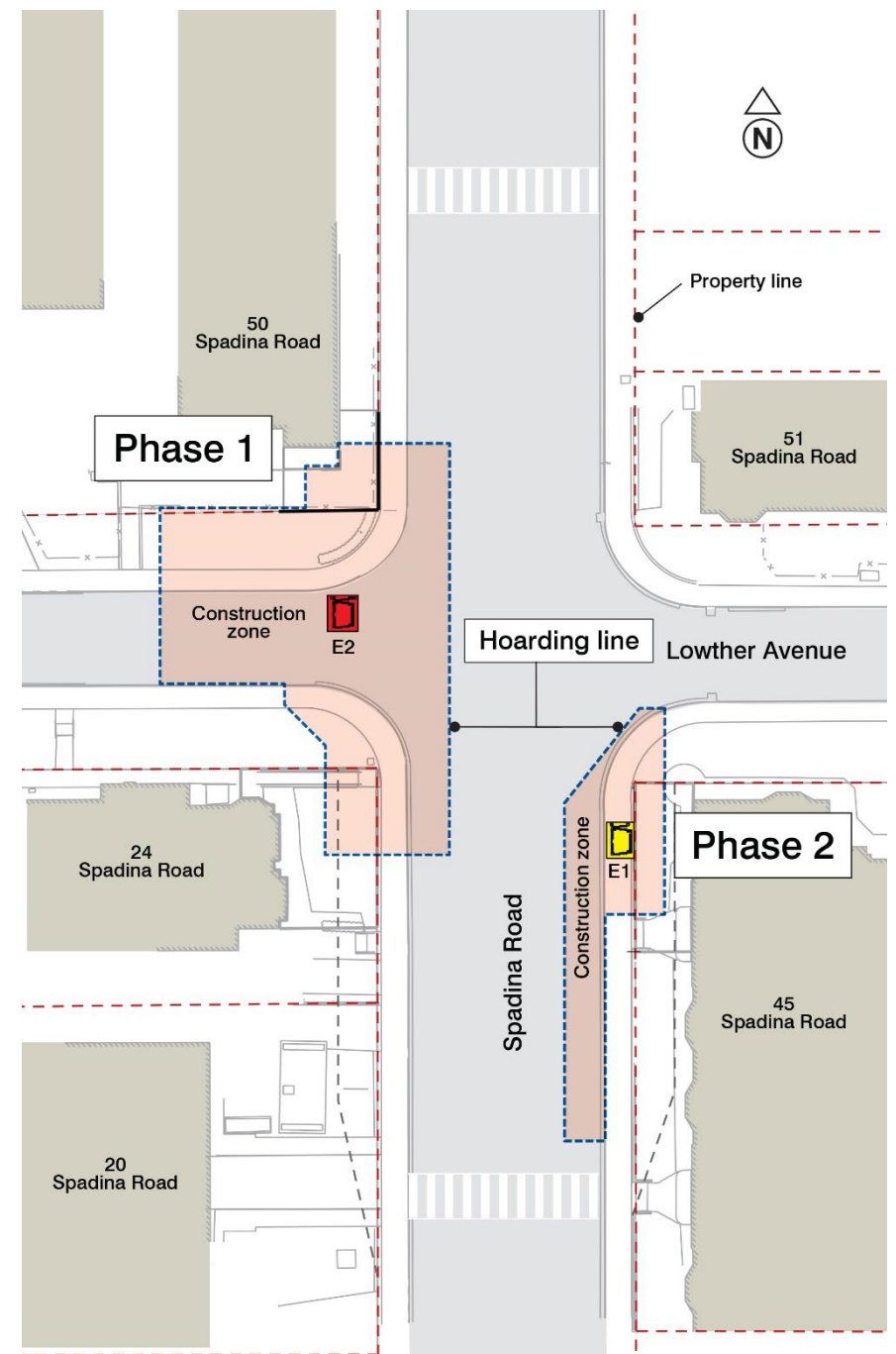

# | Phase 1 – Summer 2022 to Spring 2025\*

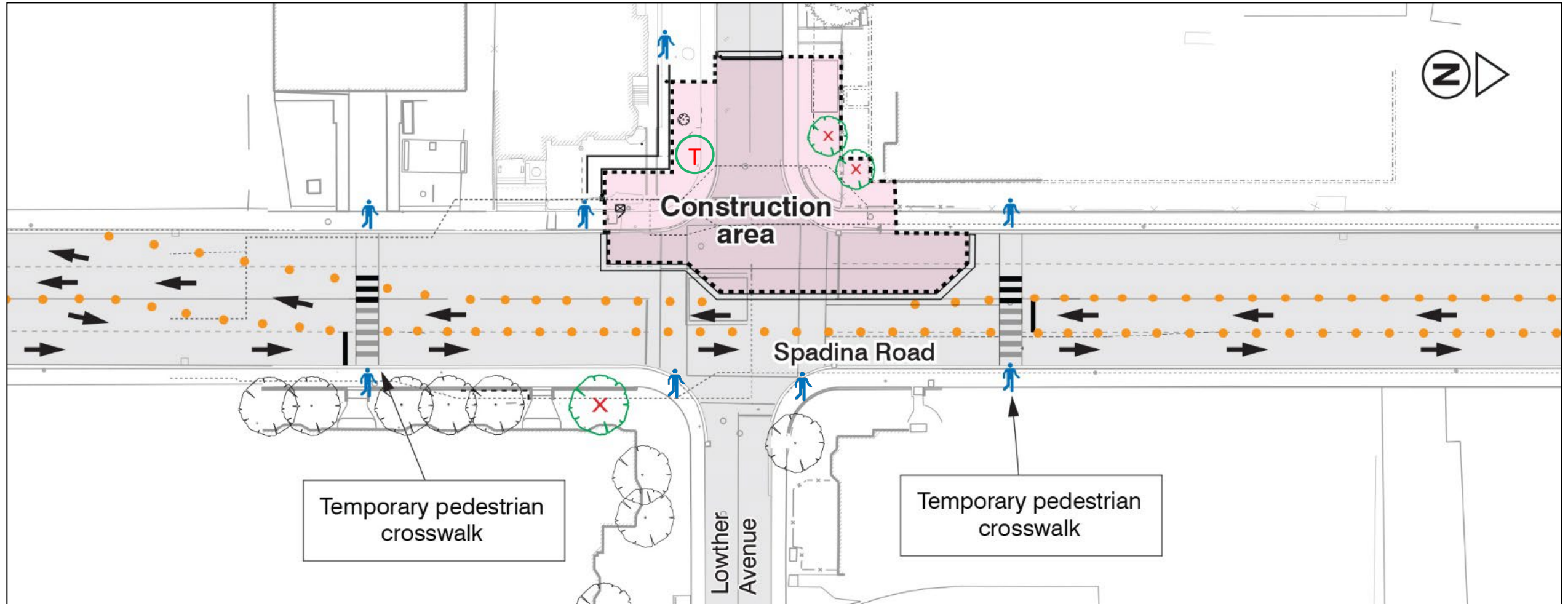

Traffic lane restrictions: one northbound lane and one southbound lane remain open

\*subject to weather and unforeseen events/circumstances; content/timeline accurate at time of communication

# | Phase 1 – Summer 2022 to Spring 2025\*

- Construction work for E2 on Lowther Ave west side of Spadina Rd, including utility investigations, utility relocations, caisson work, excavation, and building of structures.
- Traffic lane restrictions: one northbound lane and one southbound lane to remain open.
- Temporary road closures: Lowther Ave west of Spadina Rd, Lowther Ave east of Spadina Rd, and nightly closure of Spadina Rd at Lowther Ave.
- New and temporary controlled pedestrian crosswalks north and south of construction site.
- Bus stop(s) at Spadina Rd and Lowther Ave out of service at various points during construction and bus route diversion during the nightly closure.

\*subject to weather and unforeseen events/circumstances; content/timeline accurate at time of communication



## | Phase 2 – Spring 2025 to Winter 2026\*

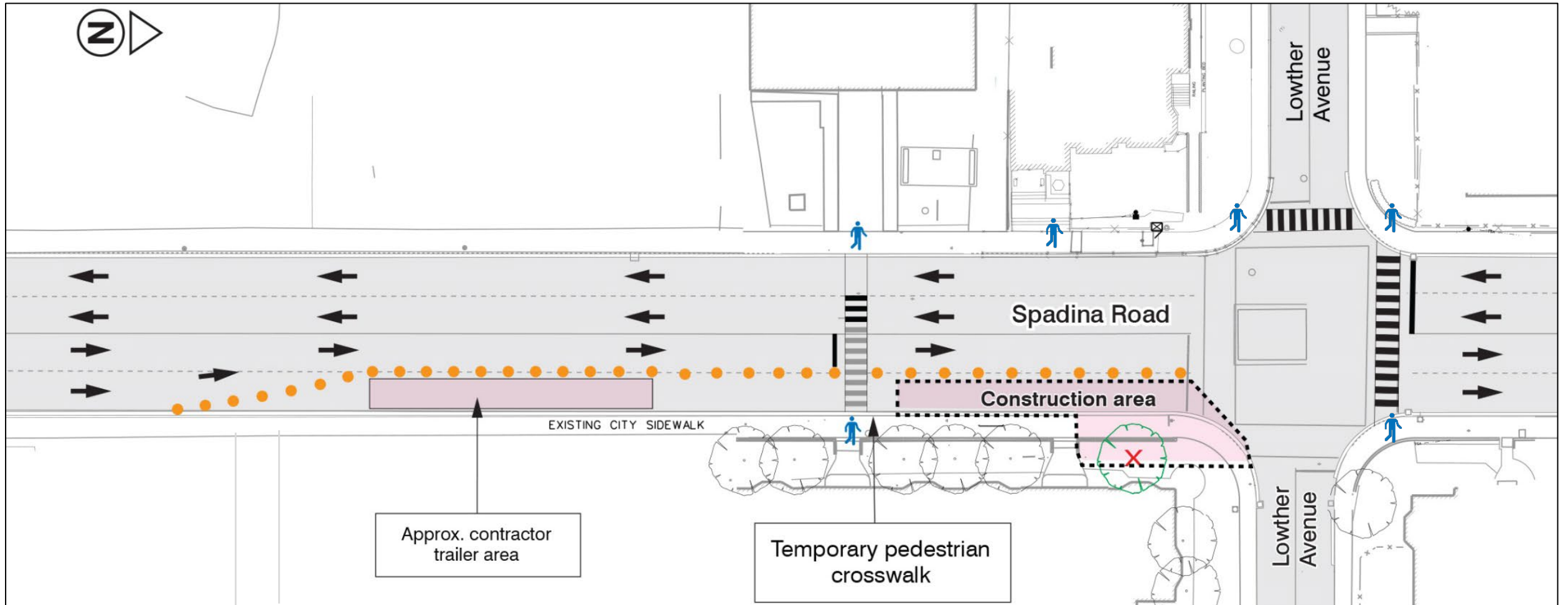

Traffic lane restrictions: one northbound lane and two southbound lanes remain open

\*subject to weather and unforeseen events/circumstances; content/timeline accurate at time of communication



## | Phase 2 – Spring 2025 to Winter 2026\*

- Construction work for E1 takes place on east side of Spadina Rd / south side of Lowther Ave, including caisson work, excavation, and building of structures.
- Traffic lane restrictions: one northbound lane and two southbound lanes remain open.
- The original north crosswalk will be reinstated; the north temporary crosswalk will be removed and the south temporary crosswalk will remain.
- Bus stop(s) at Spadina Rd and Lowther Ave out of service at various points during construction.

\*subject to weather and unforeseen events/circumstances; content/timeline accurate at time of communication



# | Impacts to Neighbourhood

- Traffic on Spadina Rd maintained with lane restrictions during both phases.
- Sidewalk closures / detours required.
- Exit/entrance of Lowther Ave west of Spadina Rd closed to traffic for Phase 1.
- Exit/entrance of Lowther Ave east of Spadina Rd closed for a part of Phase 1.
- Temporary nightly closure of Spadina Rd at Lowther Ave (local traffic only) and related bus diversion.
- Noise, vibration, and dust are expected from this construction.
- Bus stop(s) at the intersection of Spadina Rd and Lowther Ave temporarily affected.

# | Construction Details and Transit Information

- Major construction activities include utility relocations, shoring and excavation of elevator shafts to subway platform level.
- Work will typically take place Monday to Friday between 7 a.m. and 7 p.m. Some work on weekends between 9 a.m. and 7 p.m. may be required. Overnight work may be required.
- Noise, dust and vibration associated with construction is unavoidable with this work.
- Access to Spadina Station will be uninterrupted by this construction. No impacts to subway or streetcar services. Bus service interruptions expected as noted.

# | Public Art

- As with all Easier Access projects, Spadina Station will receive public art in accordance with TTC's Public Art Policy.
- Art to be installed at Spadina Station upon project completion.
- Details to be confirmed.



## | More Information

For any questions/comments or to be added to the project email list:

Reka Sivarajah, Senior Community Liaison

437-994-6317 | [Reka.Sivarajah@ttc.ca](mailto:Reka.Sivarajah@ttc.ca) | [www.ttc.ca/spadinaconstruction](http://www.ttc.ca/spadinaconstruction)

