



# **Spadina Station (Line 1)**

## **Easier Access Program Update**

### **Public Presentation**

May 2025

# Easier Access Program

- TTC's Advisory Committee on Accessible Transit (ACAT) has a critical role in making TTC accessible.
- Comprised of volunteers, ACAT helps TTC design and implement the Easier Access Programs through the lens of persons with disabilities and seniors.
- 58 of 70 subway stations are now accessible.
- Easier Access projects continue at the following stations:
  - **Spadina**, Rosedale, Christie, Warden, Summerhill, Greenwood, Islington, Lawrence, College, Museum, King, and Old Mill

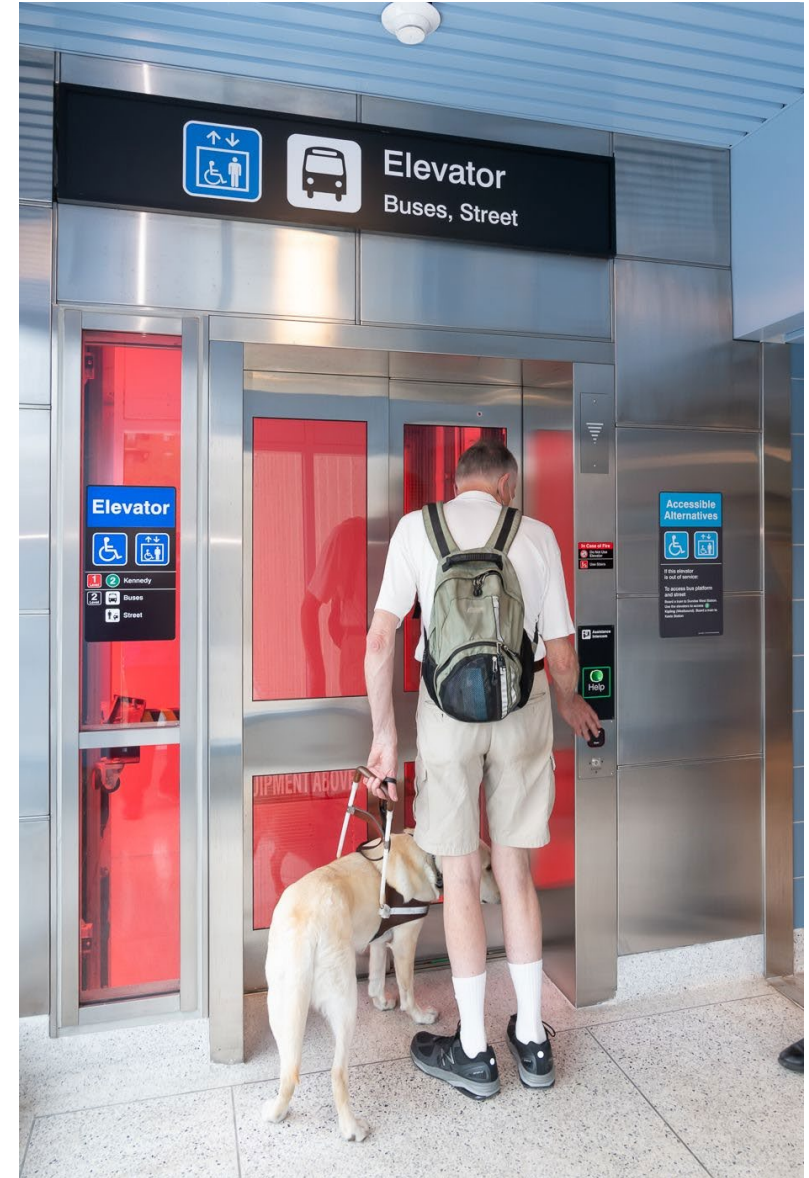

# | Spadina Station Easier Access

## Easier Access Improvements

Barrier-free path between Line 1 platform and the underground pedestrian walkway, which leads to Spadina Station Line 2, the streetcar platform, the bus terminal and the street-level entrances/exits.

- Two new elevators.
- PRESTO-enabled accessible fare gates (installed).
- Improved signage.
- CCTV – Security cameras inside of the station.

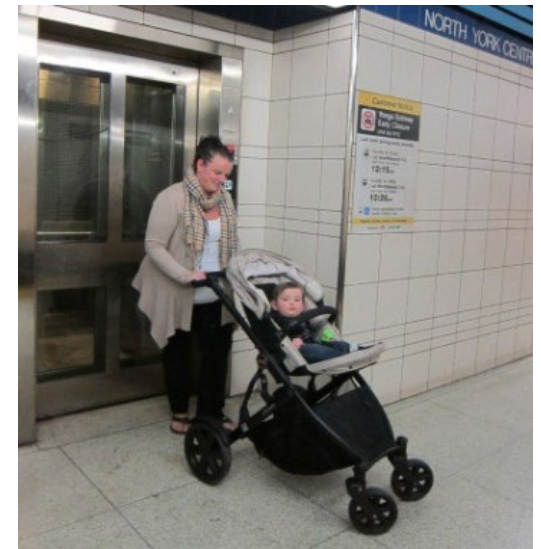



# Project Site

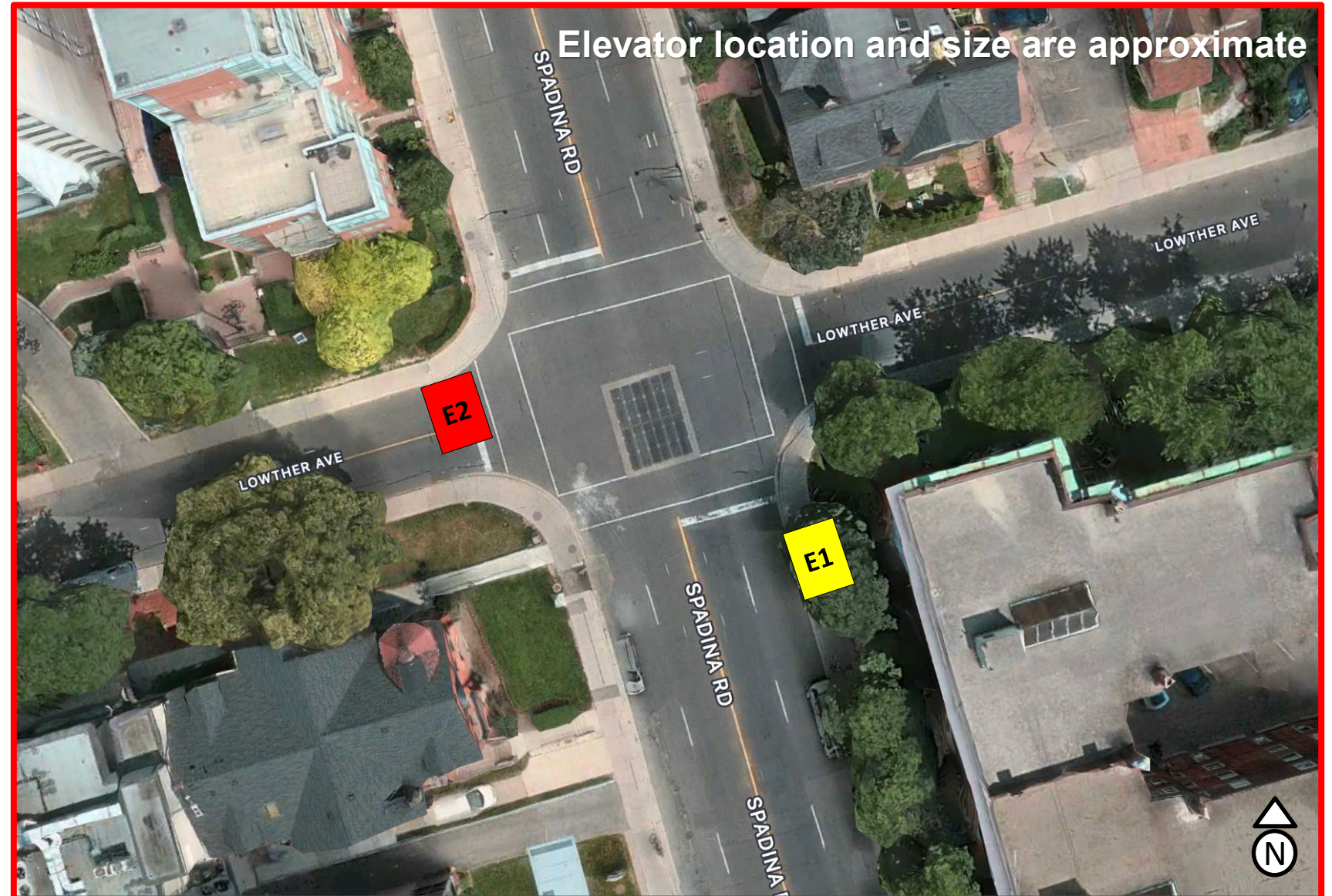
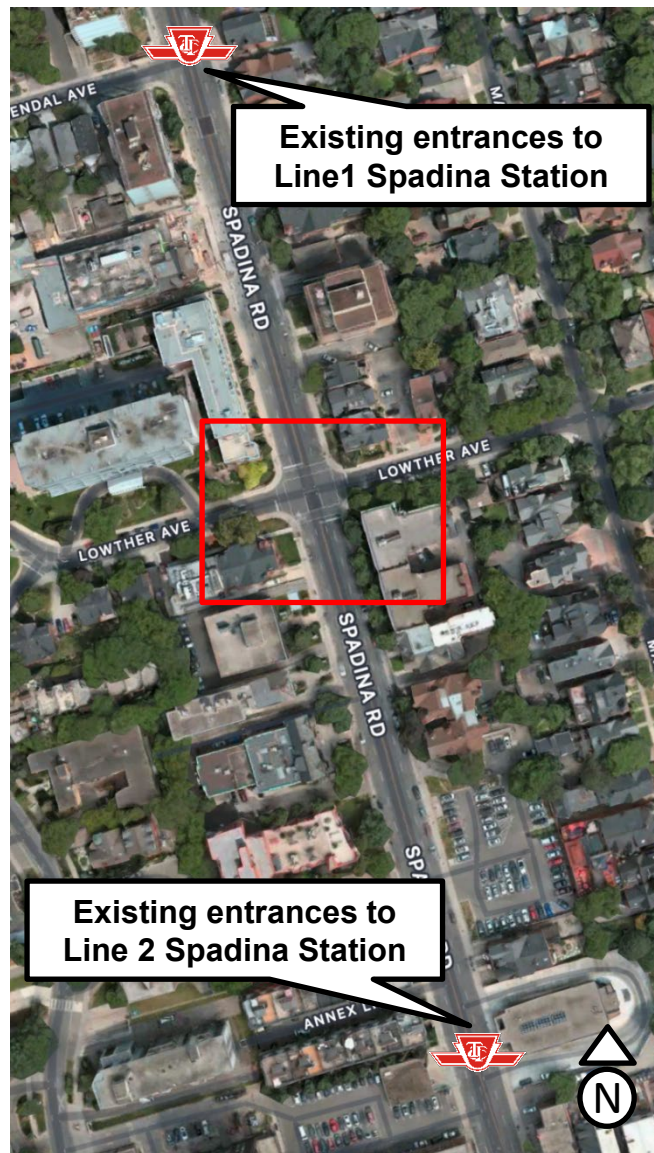



# Spadina Station Elevation Plan

## 2 Spadina Station (Bloor-Danforth)

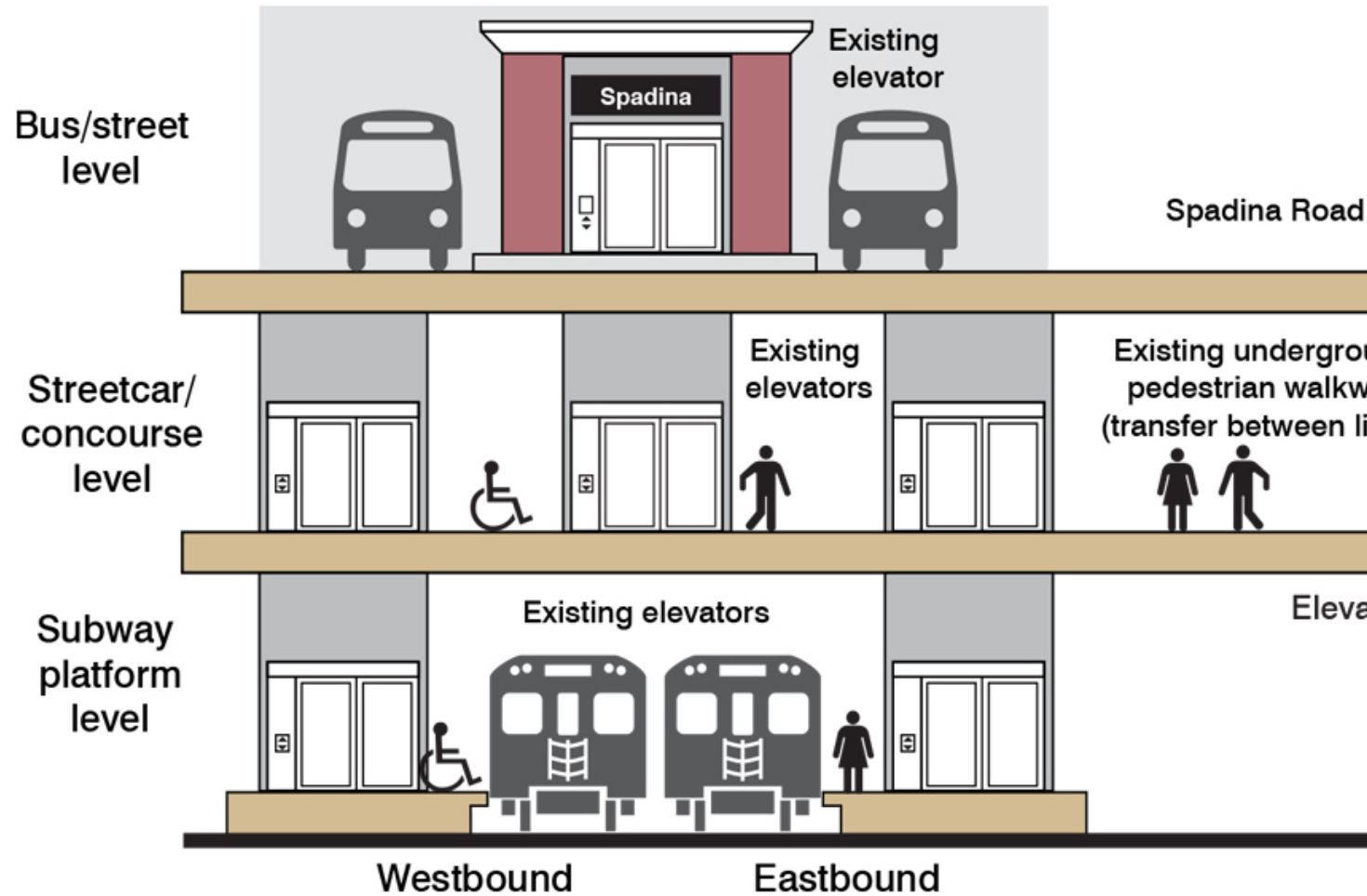

**No new elevator structure or entrance at street level for Spadina Station Easier Access**

## 1 Spadina Station (Yonge-University)

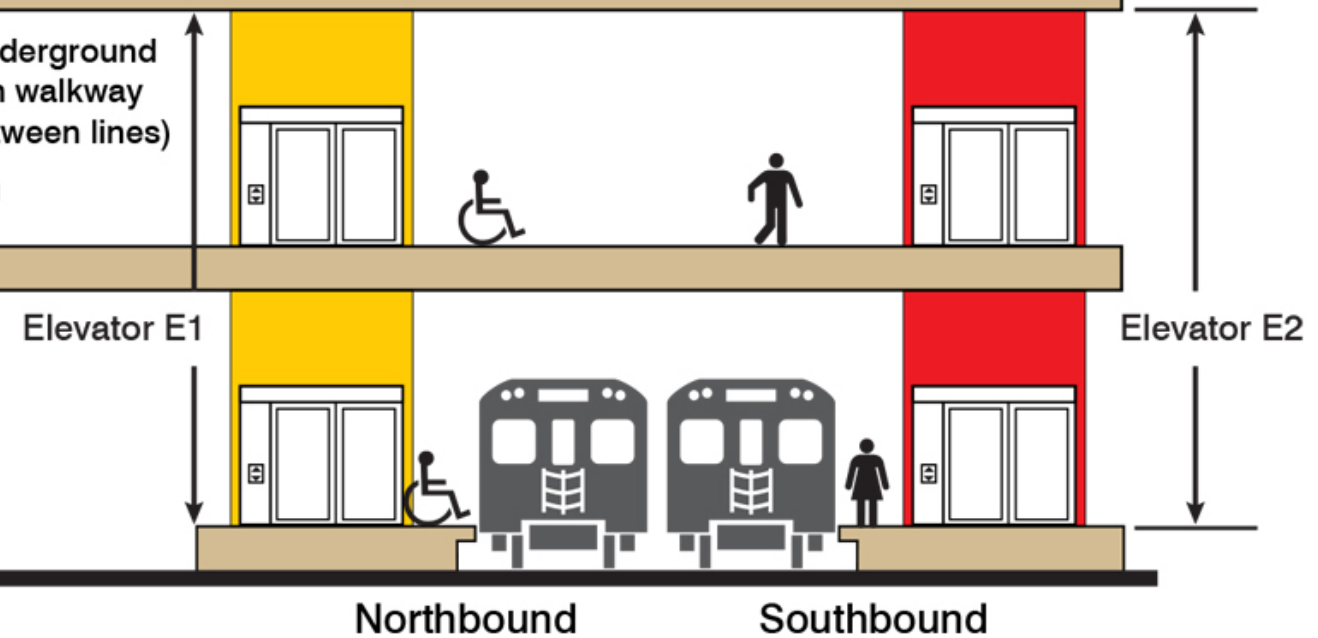

# Concourse Level: Pre-Construction

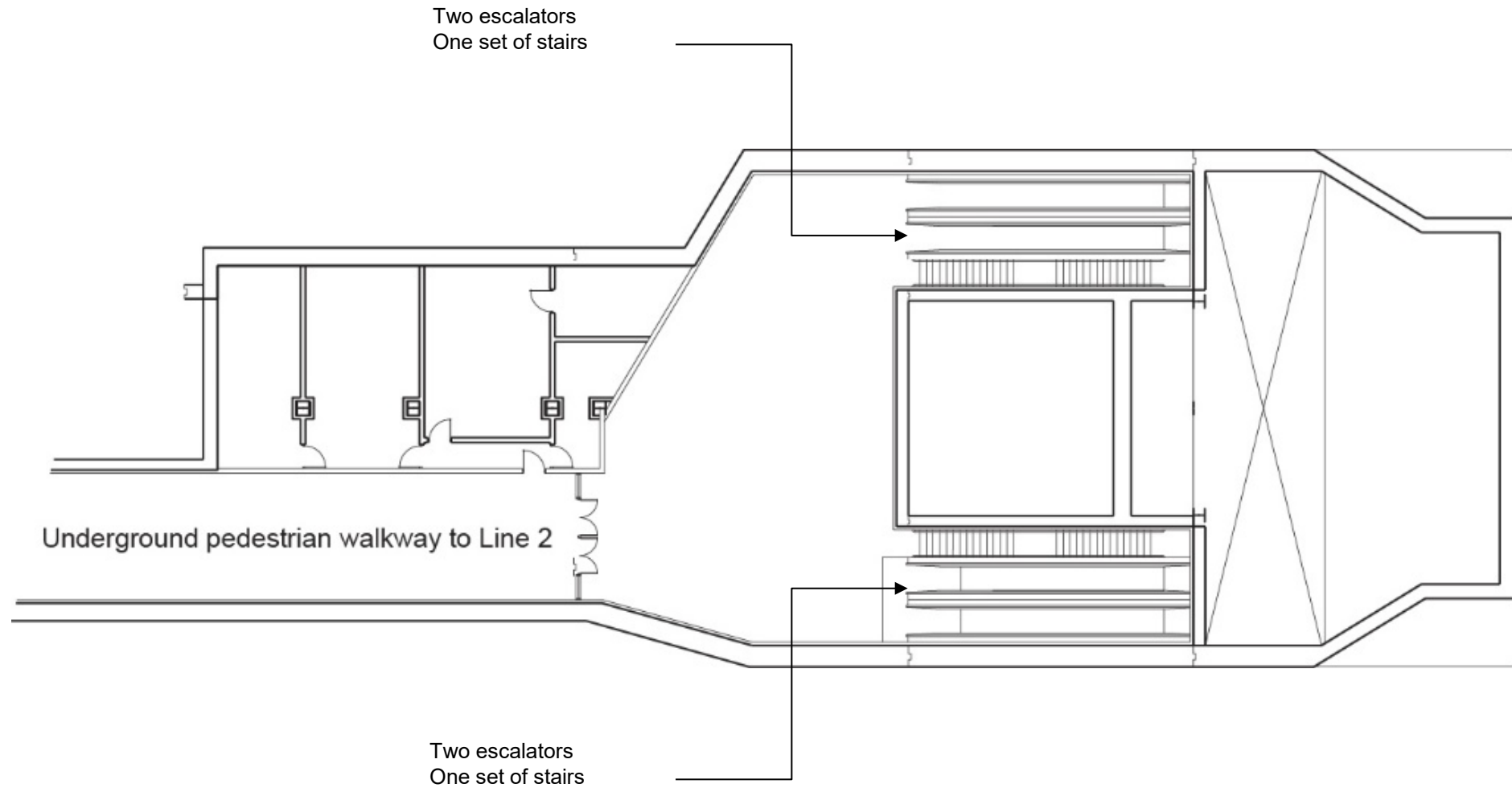

# Concourse Level: Post-Construction

**Three of the four escalators** are being permanently removed.  
**One escalator** will remain on the southbound platform.

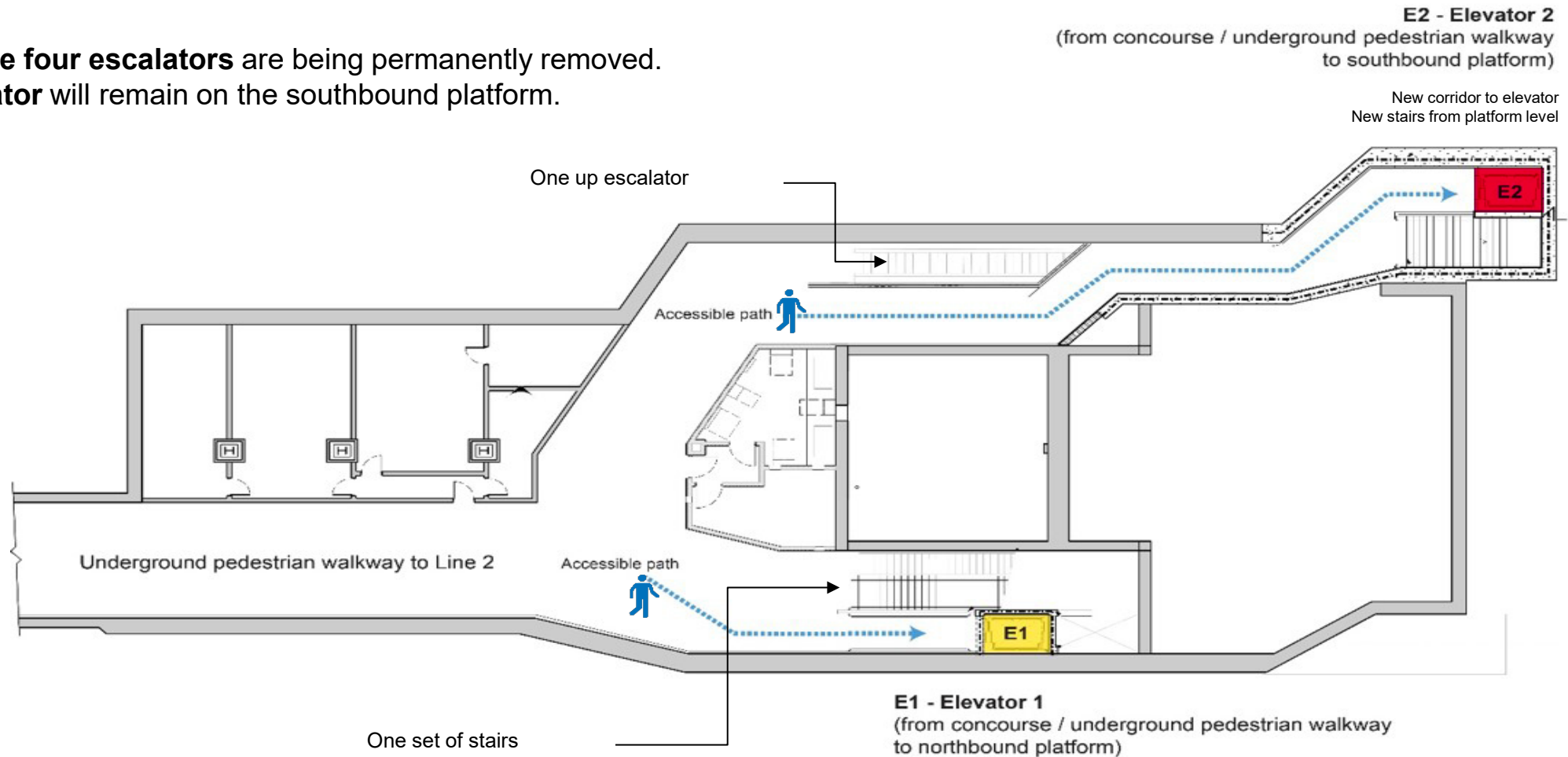

# | Platform Level: Pre-Construction

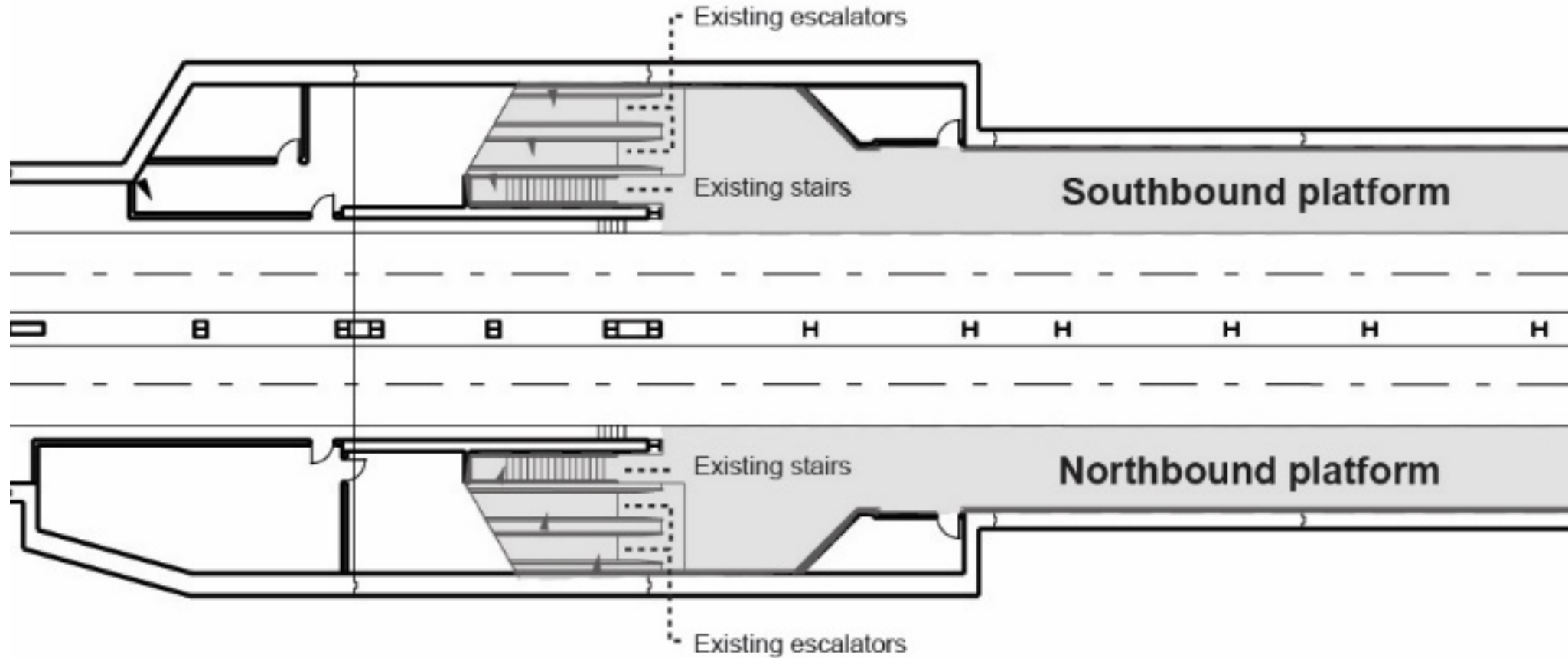



# Platform Level: Post-Construction

**Three of the four escalators** are being permanently removed.  
**One escalator** will remain on the southbound platform.

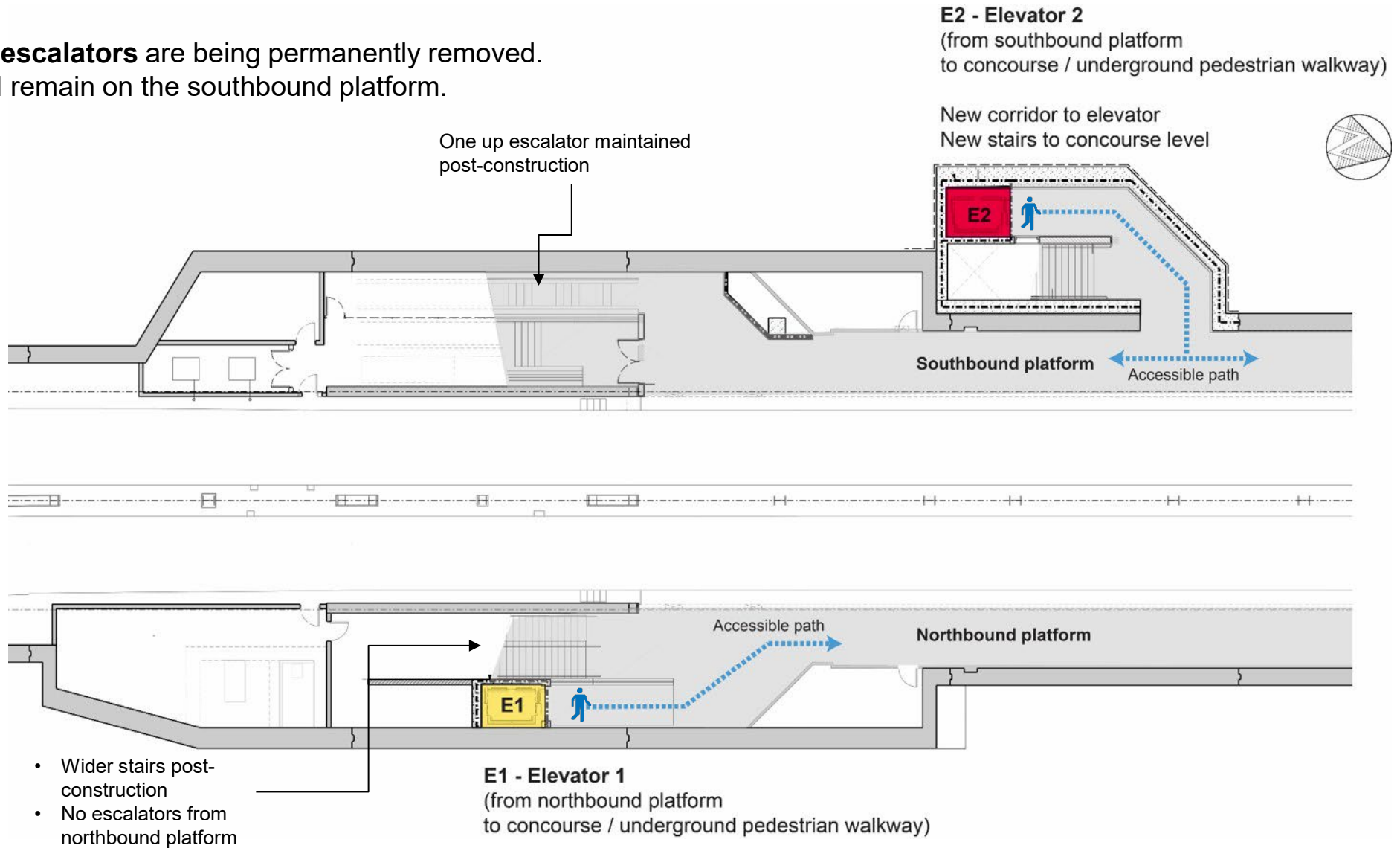

# | Phases and Staging

- The construction is at Spadina Rd and Lowther Ave at street level and near the pedestrian walkway where it meets Line 1.
- Two-phase construction project with overlapping timelines:
  - Phase 1: Utility relocations west of Spadina Rd will be completed first, followed by construction of elevator 2 (E2) west of Spadina Rd. Once construction west of Spadina Rd is complete, the area will be restored.
  - Phase 2: Construction of elevator 1 (E1) east of Spadina Rd will be completed, and the area will be restored.
  - Concurrent work inside the station for both phases.

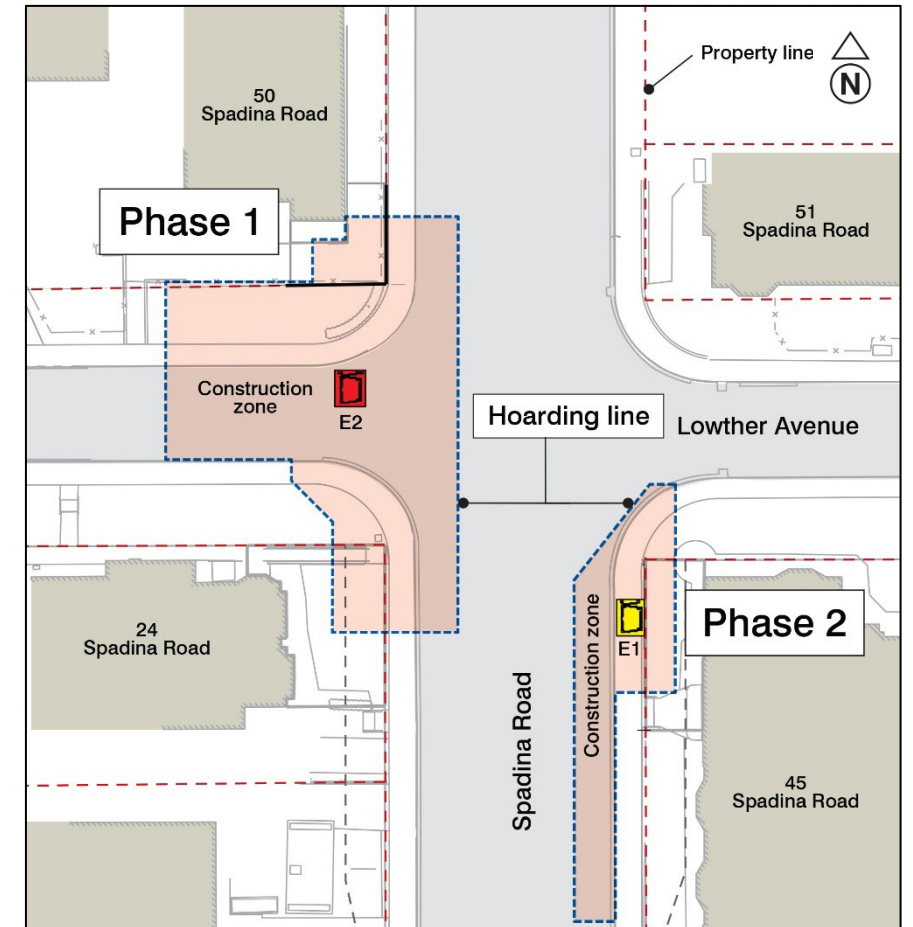

# | Phase 1 (Street Level)

**Timeline: Summer 2022 to Fall 2025\***

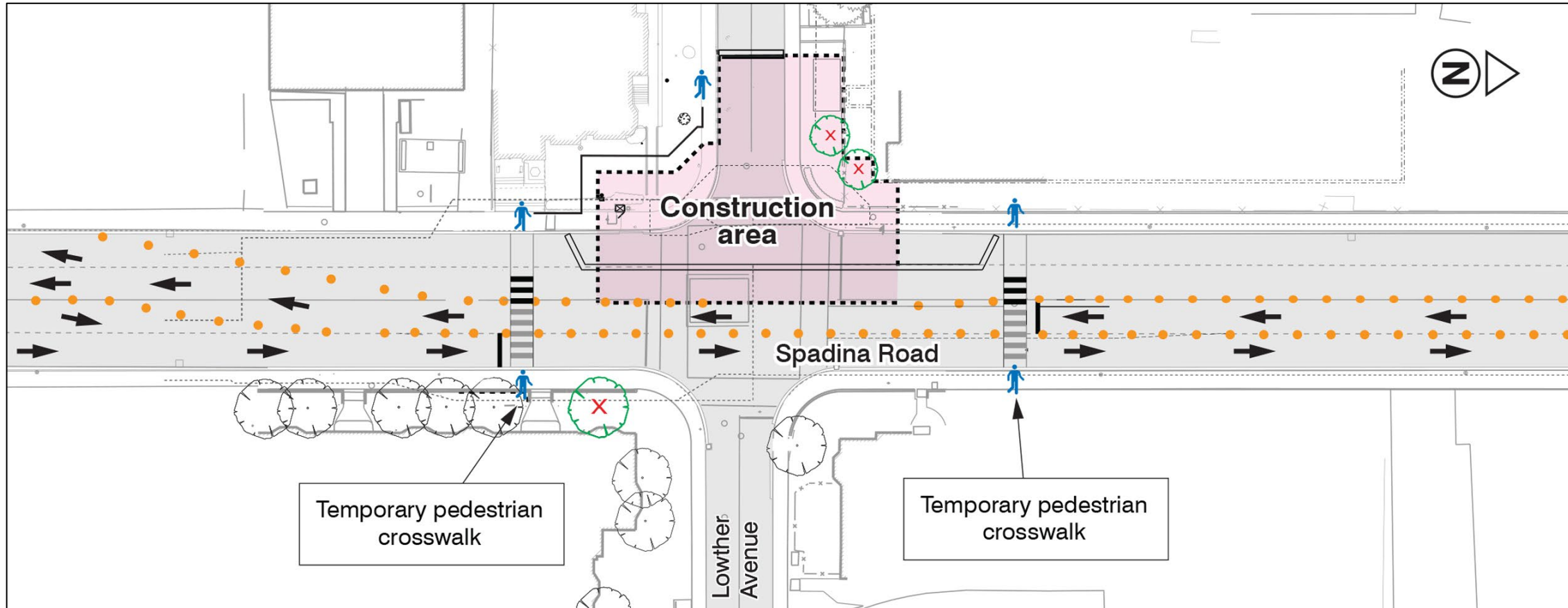

**Traffic lane restrictions: one northbound lane and one southbound lane remain open**

*\*subject to weather and unforeseen events/circumstances; content/timeline accurate at time of communication*



# | Phase 1 (Street Level)

**Timeline: Summer 2022 to Fall 2025\***

- Construction work for E2 on Lowther Ave, on the west side of Spadina Rd, including utility investigations, utility relocations, caisson work, excavation, and building of structures.
- Traffic lane restrictions: one northbound lane and one southbound lane to remain open.
- Temporary road closures: Lowther Ave west of Spadina Rd, Lowther Ave east of Spadina Rd, and nightly closure of Spadina Rd at Lowther Ave.
- New and temporary controlled pedestrian crosswalks north and south of the construction site.
- Bus stop(s) at Spadina Rd and Lowther Ave are out of service at various points during construction and bus route diversion during the nightly closure.

\*subject to weather and unforeseen events/circumstances; content/timeline accurate at time of communication



## | Phase 2 (Street Level)

**Timeline: Fall 2025 to Winter 2026\***

- Site conditions are currently being evaluated to optimize the construction space.
- Construction work for E1 takes place on the east side of Spadina Rd / south side of Lowther Ave, including caisson work, excavation, and building of structures.
- The original north crosswalk will be reinstated; the north temporary crosswalk will be removed, and the south temporary crosswalk will remain.
- Bus stop(s) at Spadina Rd and Lowther Ave are out of service at various points during construction.

\*subject to weather and unforeseen events/circumstances; content/timeline accurate at time of communication



# | Impacts

## **Street Level**

- Traffic on Spadina Rd is maintained with lane restrictions during both phases.
- Sidewalk closures/detours required.
- Exit/entrance of Lowther Ave west of Spadina Rd closed to traffic for Phase 1.
- Noise, vibration, and dust are expected from this construction.
- Bus stop(s) at the intersection of Spadina Rd and Lowther Ave are temporarily affected.

## **Inside the Station**

- Removal of all four escalators connecting the concourse level to Line 1 platforms, with one of them to be recommissioned in 2026.



# | Construction Details and Transit Information

- Major construction activities include utility relocations, shoring, and excavation of elevator shafts to the subway platform level.
- Construction work is expected to occur Monday to Friday between 7 a.m. and 7 p.m. Some work on weekends and overnight may be required.
- Noise, dust, and vibration associated with construction are unavoidable with this work.
- Access to Spadina Station will be uninterrupted by this construction. No impacts to subway or streetcar services. Bus service interruptions are expected as noted above.

# | Public Art

- As with all Easier Access projects, Spadina Station will receive public art in accordance with TTC's Public Art Policy.
- Art to be installed at Spadina Station upon project completion.
- Details to be confirmed.

## | More Information

For any questions/comments or to be added to the project email list:

Website: [www.ttc.ca/SpadinaConstruction](http://www.ttc.ca/SpadinaConstruction)

Contact: Reka Sivarajah, Senior Community Liaison  
437-994-6317 | [Reka.Sivarajah@ttc.ca](mailto:Reka.Sivarajah@ttc.ca)



