



Making Sherbourne Station Accessible

Date: June 12, 2019
To: TTC Board
From: Chief Capital Officer

Summary

The purpose of this report is to obtain authorization for the award of Contract D45-5 Easier Access Phase III Sherbourne Station to EllisDon Civil Ltd. in the amount of \$11,410,646.42 (including all applicable taxes) on the basis of lowest total bid price.

The work for Contract D45-5 Easier Access Phase III (EA III) Sherbourne Station includes construction and installation of two elevators and other associated works.

Recommendations

It is recommended that the Board authorize the:

1. Award of Contract D45-5 Easier Access Phase III Sherbourne Station to EllisDon Civil Ltd. in the amount of \$11,410,646.42, inclusive of all taxes, on the basis of lowest total bid price.

Financial Summary

Once approved, Contract D45-5 Sherbourne Station – Easier Access Phase III will require \$11,410,646.42, which will be expended from 2019 to 2021 approximately. Funds for this expenditure are included in the TTC's 2019-2028 Capital Budget under Program 3.9 Buildings & Structures, Easier Access Phase III Project, Legislative Category that was approved by City Council on March 7, 2019. The Easier Access Phase III total project approval is approximately \$830 million of which approximately \$339 million has been committed to date.

The Chief Financial Officer has reviewed this report and agrees with the financial impact information.

Equity/Accessibility Matters

A cornerstone of the TTC's Corporate Plan 2018-2022 is accessibility and as a proud leader in providing accessible public transit in the City of Toronto, we are committed to ensuring reliable, safe and inclusive transit services for all our customers.

This is supported through the work of this Contract for Sherbourne Station. An accessible path will be provided from street level to concourse level and to the eastbound and westbound platforms by two forward motion elevators, along with the associated equipment and finishes.

The construction work is not expected to affect access to the station or to the sidewalks leading to the station.

Decision History

In order to meet the 2025 required completion date, the Easier Access Phase III Program schedule has been accelerated where possible. For further project background and history refer to:

[https://www.ttc.ca/About the TTC/Commission reports and information/Commission meetings/2016/October 27/Reports/7 Feasibility of Acceleration Easier Access %20 III.pdf](https://www.ttc.ca/About%20the%20TTC/Commission%20reports%20and%20information/Commission%20meetings/2016/October%2027/Reports/7%20Feasibility%20of%20Acceleration%20Easier%20Access%20III.pdf)

Issue Background

TTC started work to make subway stations accessible to people with disabilities in 1990 and has a target to complete all subway stations by 2025. To date, 45 stations are accessible.

The current program schedule is meeting this commitment with eight stations currently in construction: Lansdowne, Royal York, Yorkdale, Dupont, Chester, Runnymede, Wilson and Wellesley Stations. Including Sherbourne, an additional three stations are expected to commence construction in 2019.

The Sherbourne Station Easier Access design was presented for review to the ACAT Design Review Subcommittee. Their comments were addressed and incorporated in the final design.

Councillor Kristyn Wong-Tam has been updated on the project status. A public open house will be conducted to discuss the construction plans with the community.

Contract D45-5 Easier Access Phase III – Sherbourne Station provides for the work related to the supply and installation of two elevators for a barrier-free path from street to platform levels and associated work including automatic sliding doors, ceilings and wayfinding signage. The station layout drawings describing this work are included in Appendix A.

Comments

The Request for Bids (RFB) was posted on the TTC's website and MERX on February 20, 2019. Of the nine companies that downloaded the bid documents, five submitted a bid by the closing date of April 26, 2019, which are summarized in Appendix B. The bid validity expires on August 24, 2019.

The RFB stated that the Bidders must possess a valid Certificate of Recognition (COR™), with the Infrastructure Health and Safety Association (ISHA), at the time of the bid closing and for the duration of the term of the Contract.

EllisDon Civil Ltd. (EllisDon) submitted the lowest priced bid and did not state any exceptions or qualifications, and they are COR™ certified with IHSA. Reference checks were completed that indicated they have satisfactorily performed work of a similar size and nature. Their bid is considered commercially acceptable.

Duron Ontario Ltd. submitted the second lowest priced bid, is COR certified with IHSA, and did not state any exceptions or qualifications. Their bid is considered commercially acceptable.

J.J. McGuire General submitted the third lowest priced bid, is COR certified with IHSA, and did not state any exceptions or qualifications. Their bid is considered commercially acceptable.

The Agreement to Bond, submitted by EllisDon, covers both a Labour and Material Payment Bond and a Performance Bond. It was submitted by Chubb Insurance Company of Canada, which has been verified as a Surety Company licensed to transact business under the Insurance Act of Ontario. As such, it is considered financially capable of performing the work.

EllisDon will be required to execute both a Performance Bond and a Labour and Material Payment Bond, each in the amount of 50% of the contract value.

This Easier Access contract at Sherbourne Station is part of the TTC's plan to make the system accessible by 2025.

Contact

Jane Murray, Chief Project Manager - Construction
416-590-6811
Jane.murray@ttc.ca

Signature

Susan Reed Tanaka
Chief Capital Officer
Susan.ReedTanaka@ttc.ca

Attachments

Attachment 1 – Appendix A – Station Layout
2 – Appendix B – Summary of Bids

03075-5174-5

APPENDIX A – STATION LAYOUTS

Street Level Plan

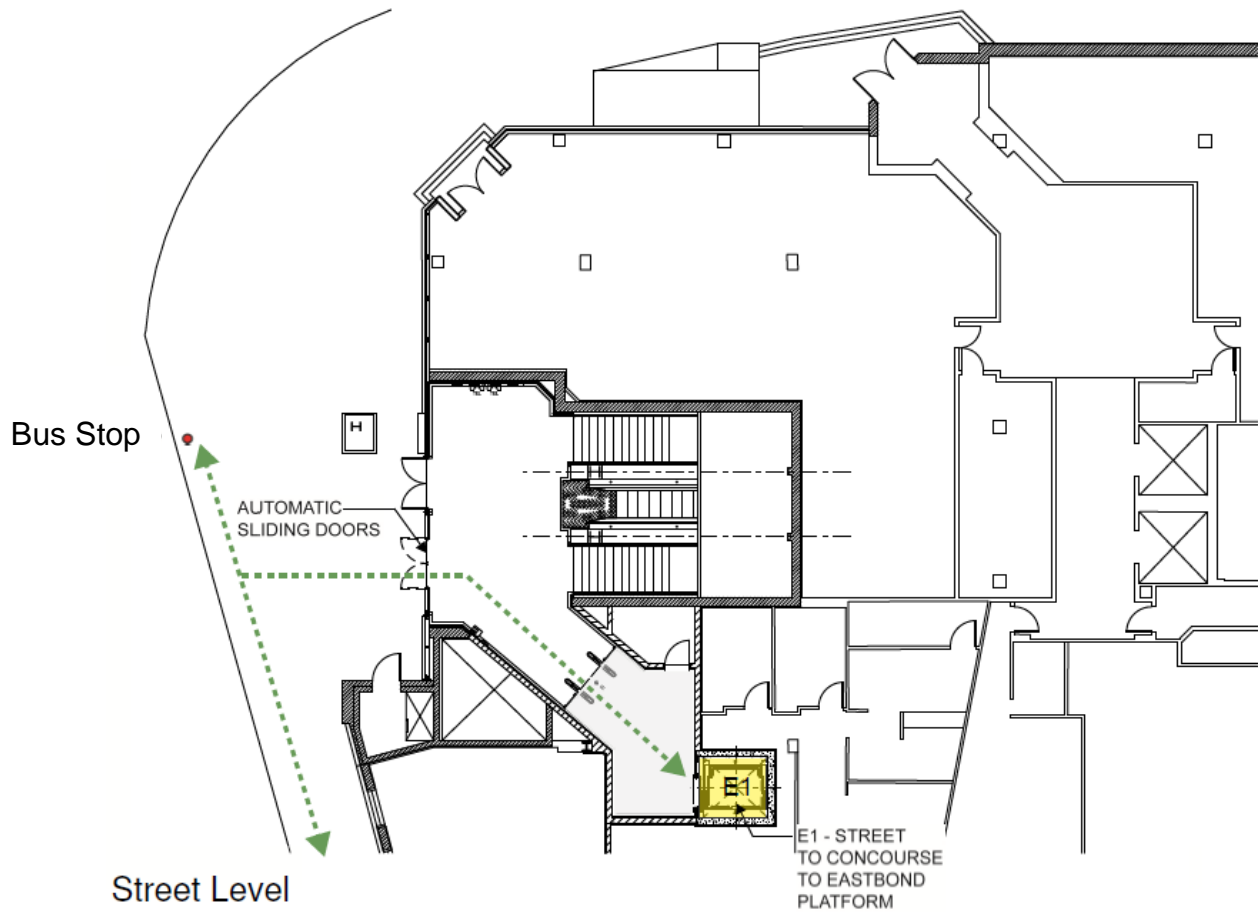

APPENDIX A – STATION LAYOUTS

Concourse Level Plan

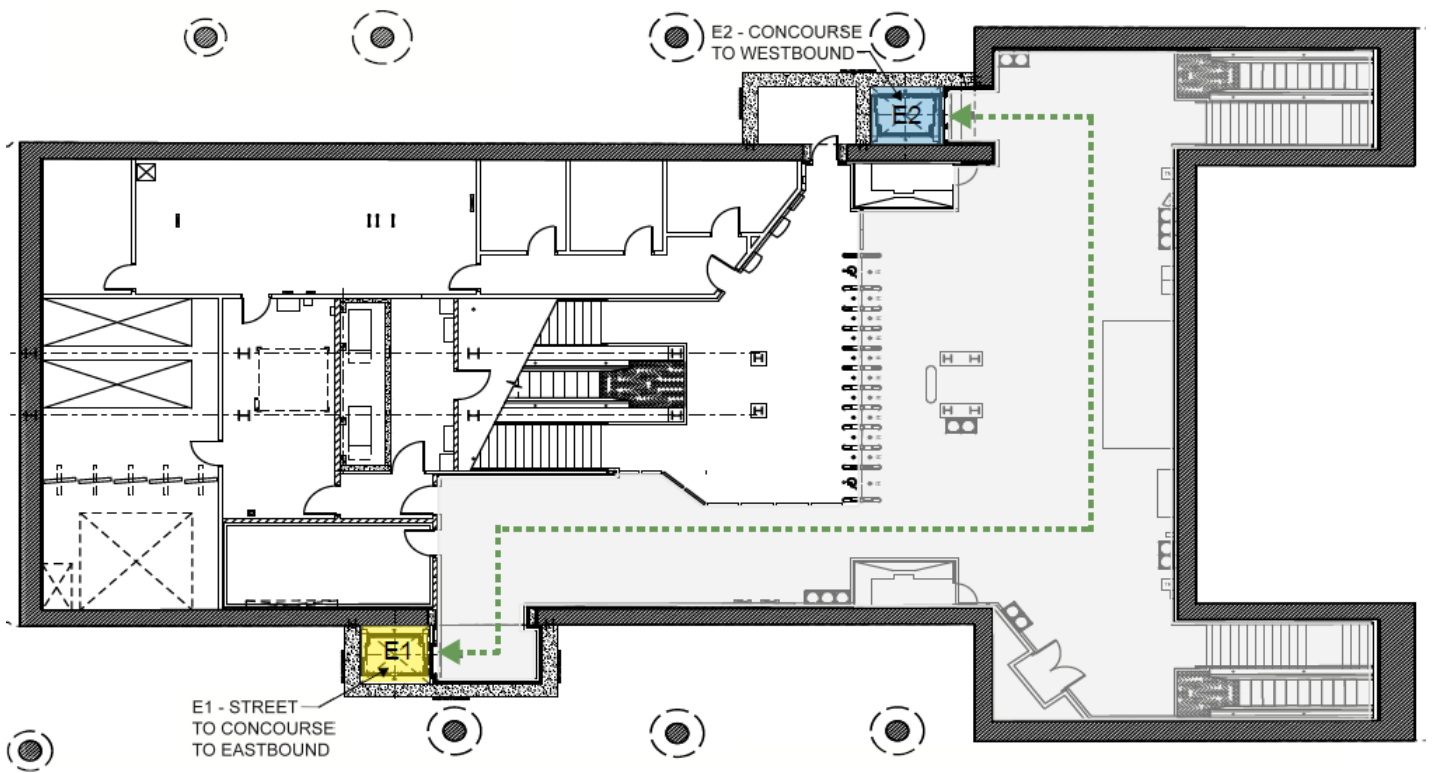

APPENDIX A – STATION LAYOUTS

Platform Level Plan

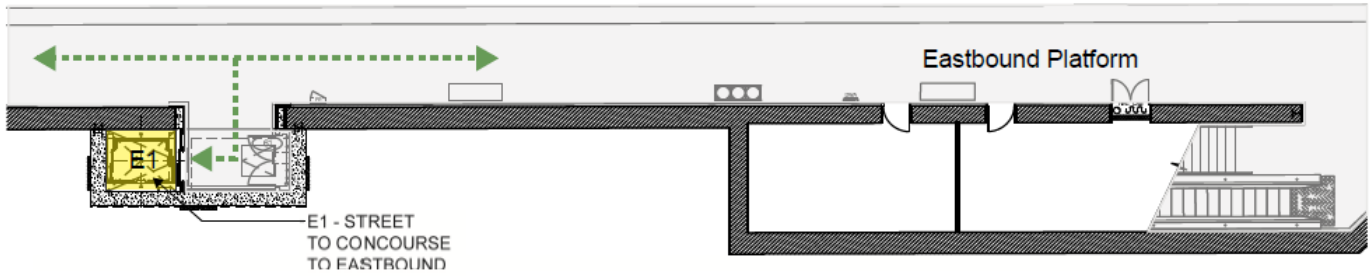
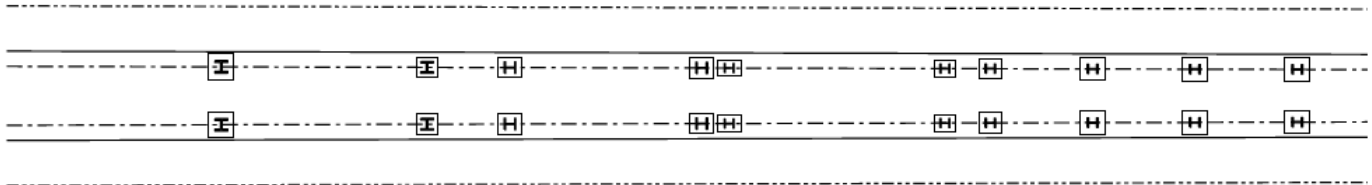
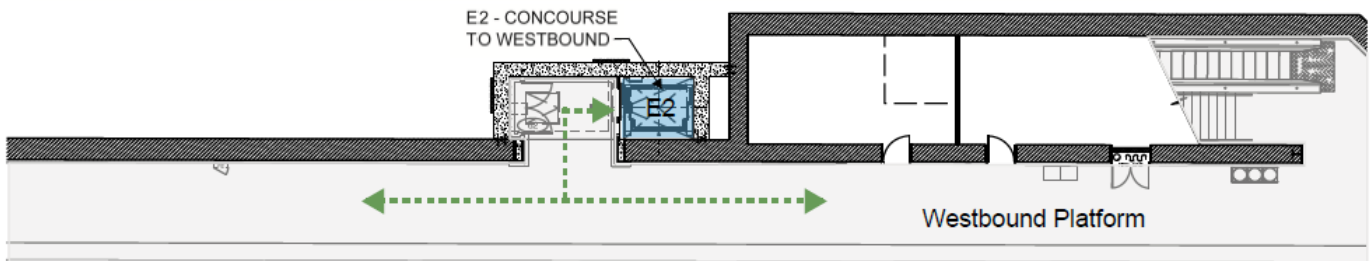

APPENDIX B

Easier Access Phase III Sherbourne Station D45-5

Summary of Bids

Bid No.	Bidder	Total Bid Price
1	EllisDon Civil Ltd.*	\$11,410,646.42
2	Duron Ontario Ltd.	\$12,091,000.00
3	J. J. McGuire General Contractors Inc.	\$12,878,610.00
4	Maystar General Contractors Inc.	\$13,884,875.00
5	Aplus General Contractor Corp.	\$14,571,350.00

* Recommended Company