



Easier Access Project TTC Greenwood Station

Public Pre-Construction Presentation
Fall 2021

| Status of Easier Access Program

- 53 stations are now accessible.
- Keele Station was the latest to become accessible.
- Easier access work continues at the following stations:
Donlands, College, Sherbourne, Yorkdale and Lansdowne.
- In 2021, the TTC is scheduled to begin Easier Access construction at the following stations:



Castle Frank, Christie, Glencairn, **Greenwood**, Rosedale and Summerhill.

| Advisory Committee on Accessible Transit (ACAT)

ACAT Overview

- Toronto citizens who advise the TTC on difficulties faced by people with disabilities and seniors
- Recommends the elimination of barriers to accessible public transit in the city of Toronto
- ACAT consists of 15 volunteer committee members who are appointed by the TTC Board



ACAT's Role

- Represents the needs and concerns of persons with disabilities and seniors who use public transit services provided by the TTC.
- Advises the TTC on the provision of accessible public transit.
- Advises the TTC on necessary policy issues for services that pertain to the interests of persons with disabilities and seniors.
- Supports TTC staff in consulting, educating and advising persons with disabilities, seniors and the community at large.
- Subcommittees: Design Review, Service Planning, Communications, Wheel-Trans Operations
- Advises the TTC on priority and plans for Easier Access projects

| Greenwood Station - Easier Access Improvements

TTC will make Greenwood Station accessible with new elevators at the existing main entrance building. This work will include:

Barrier-free path from the main entrance to all levels of the station including installation of:

- 2 elevators to access eastbound and westbound platforms
- Automatic sliding station entry doors
- Improved signage
- CCTV – Security cameras along the accessible pathway

The Easier Access improvements are reviewed by ACAT (Advisory Committee on Accessible Transit).

| Easier Access Program

- Program to make all stations accessible
- Elevators, sliding doors, accessible fare-gates
- Elevators are built at the station entrance

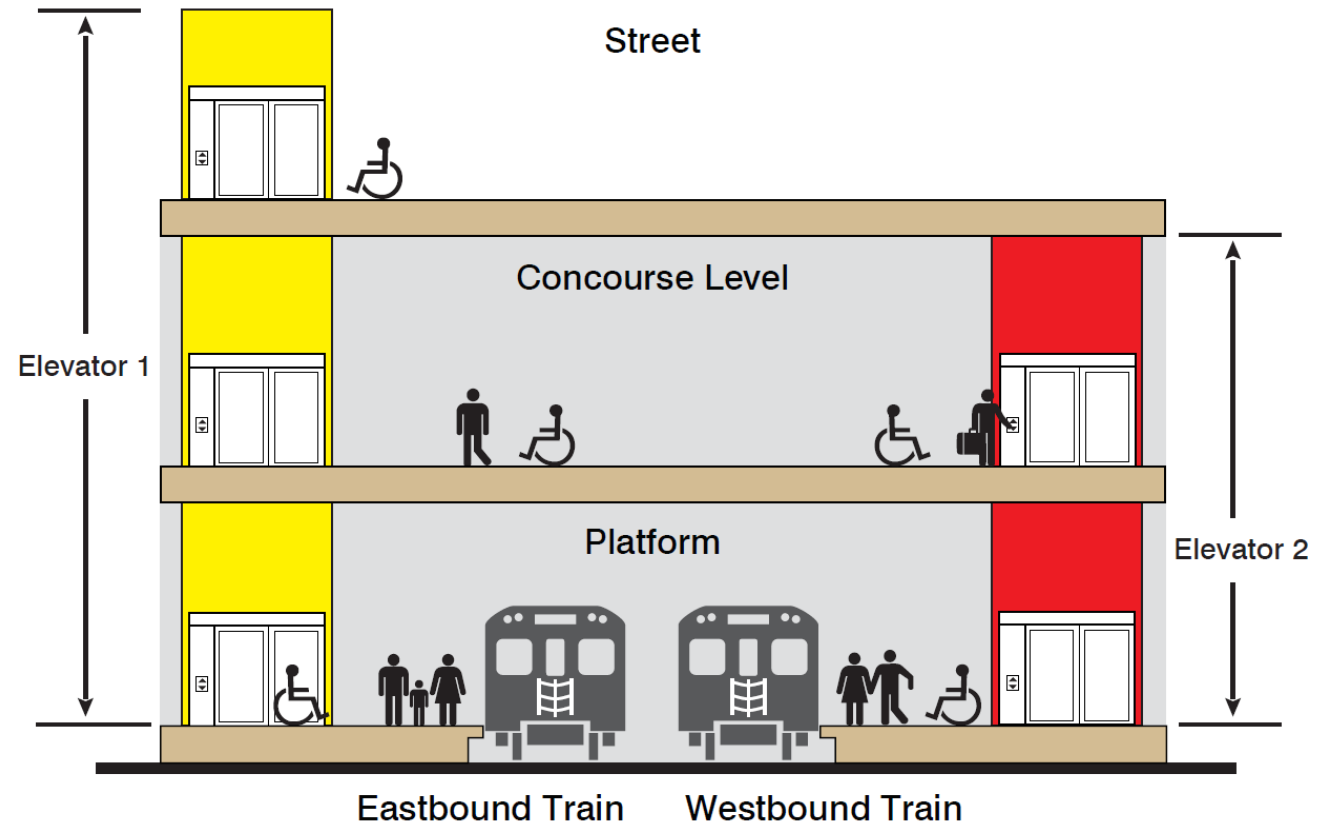

Greenwood Station elevator section image

Greenwood Station Elevator Site Plan



E1 – Street-level location of new elevator to access the street-to-concourse-to eastbound subway platform level.

E2 – Underground location of new elevator to access the concourse-to westbound platform subway level.

Nearby Stations – Accessibility and Construction Schedule

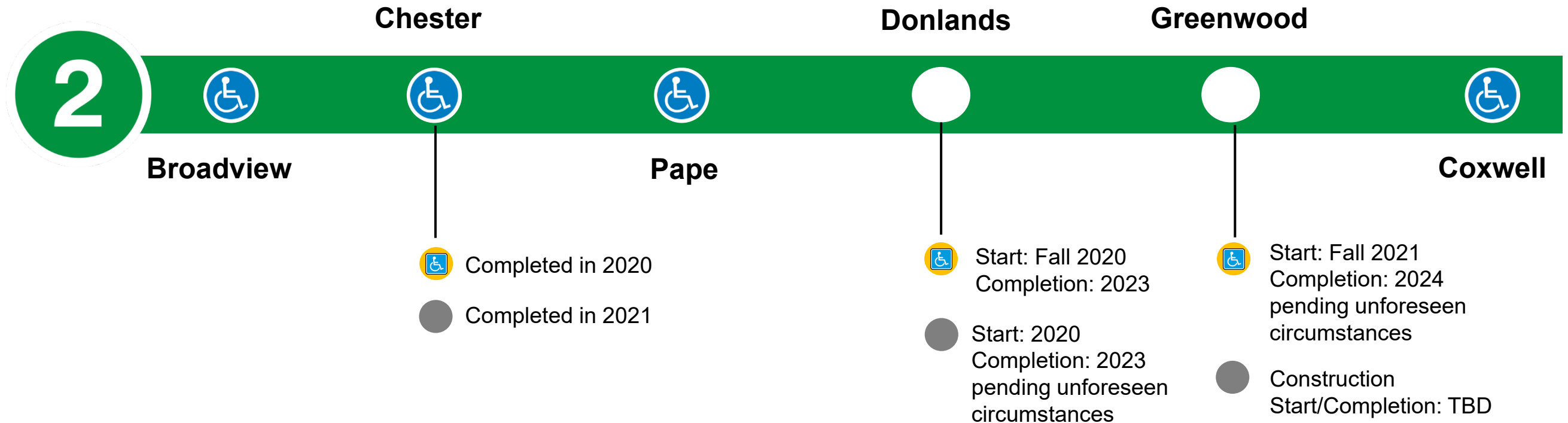

Accessible station



Active Construction



Easier Access



Second Exit/Entrance



| Greenwood Station Project schedule

October 7, 2021

Pre-construction community meeting online

Fall 2021

Start construction on elevator project
(pending approval)

**Dec 2023
Q1 2024**

Elevators in service
Construction complete



Examples of Easier Access Construction



- **Coxwell Station**
Caisson installation to stabilize soil and create safe work zone.



- **Chester Station**
Excavation for elevators.

| Conceptual staging plans

- The following slides include conceptual staging plans - provided for illustrative purposes only.
- **Plans are subject to change** as information and the construction planning is finalized by the contractor and later approved by the City of Toronto, Transportation Services.

Conceptual Staging - Phase 1 (approx. 4 weeks)

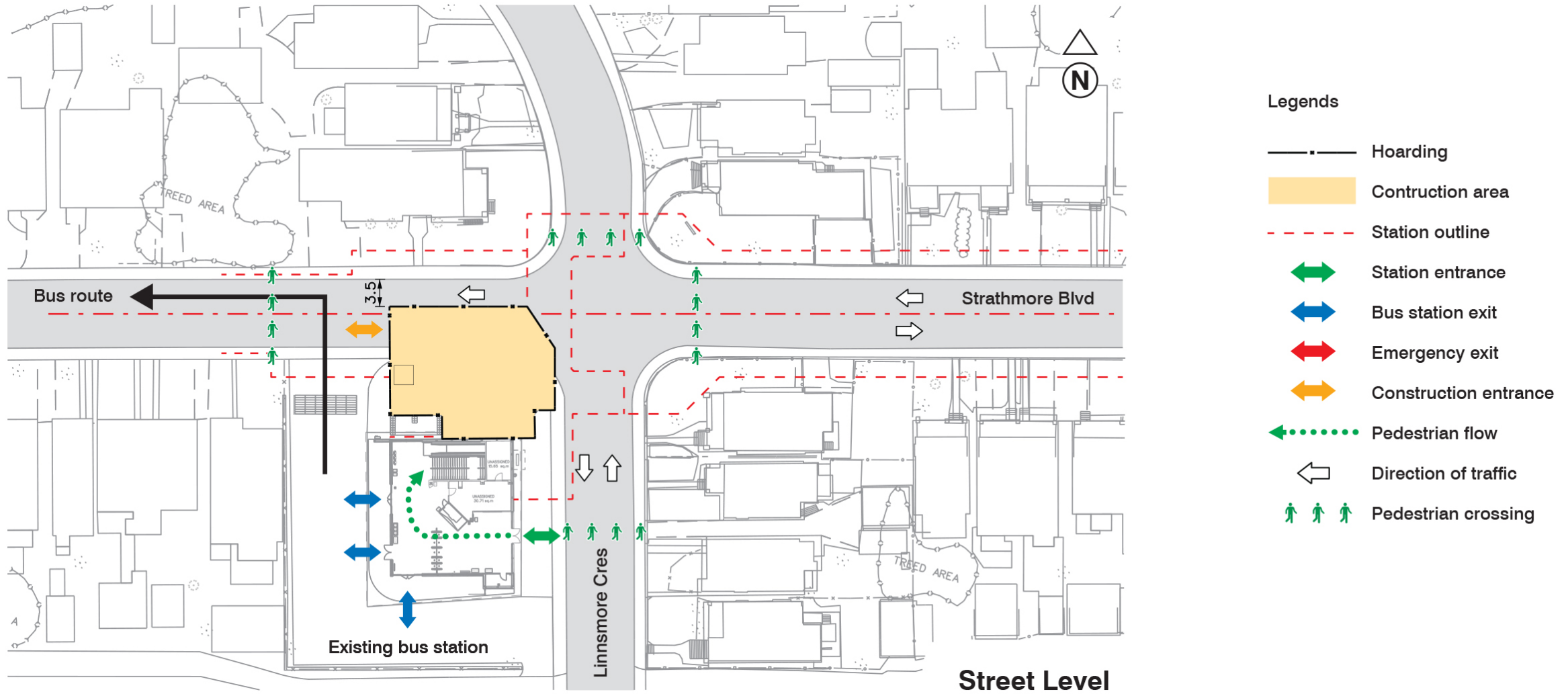

Plans are subject to change

Conceptual Staging - Phase 2 (approx. 3 months)

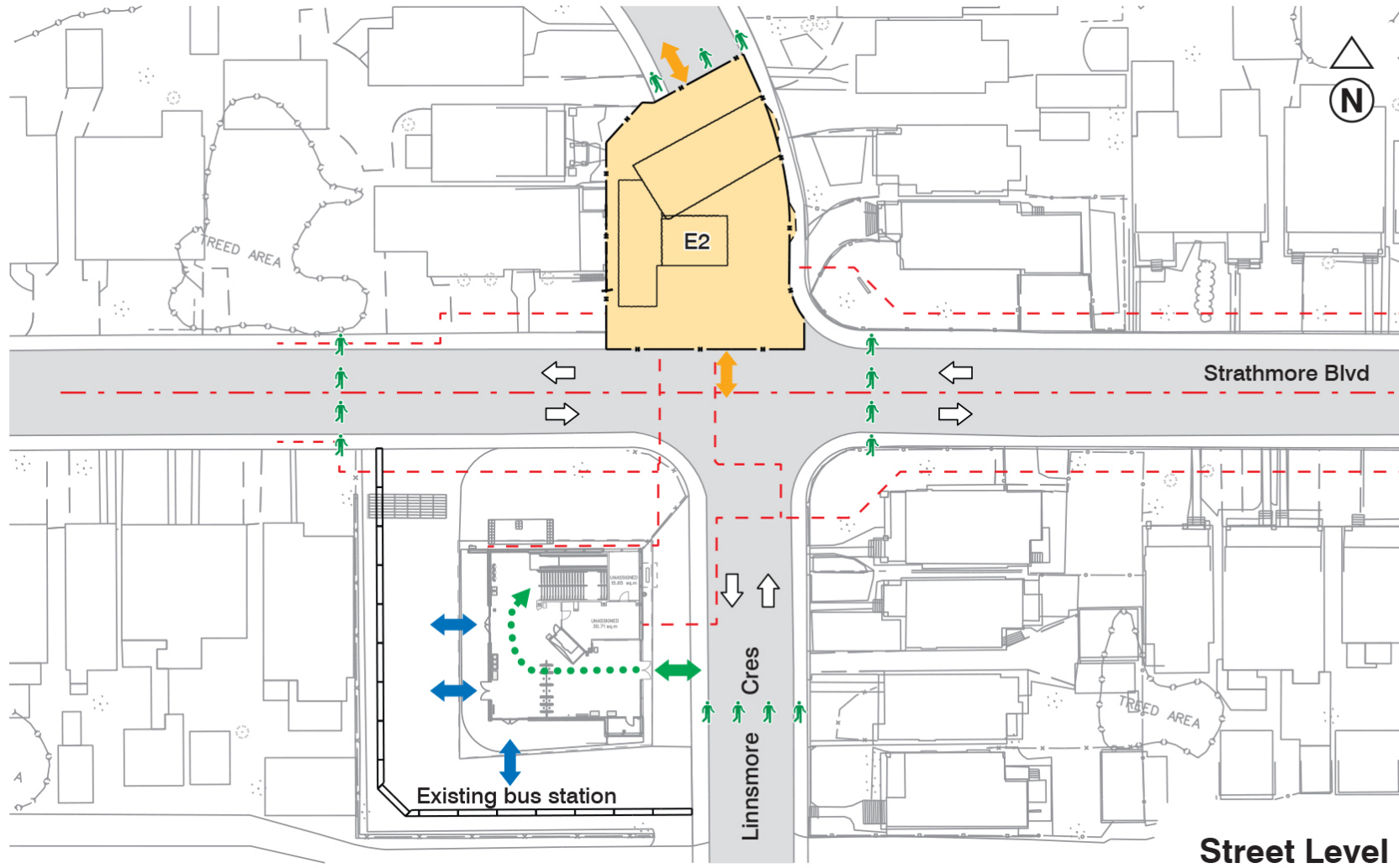

Legends

- · — Hoarding
- Construction area
- - - Station outline
- Station entrance
- Bus station exit
- Emergency exit
- Construction entrance
- Pedestrian flow
- Direction of traffic
- Pedestrian crossing

Plans are subject to change

Conceptual Staging - Phase 3 (Phase 3 & 4 combined approx. 15 months)

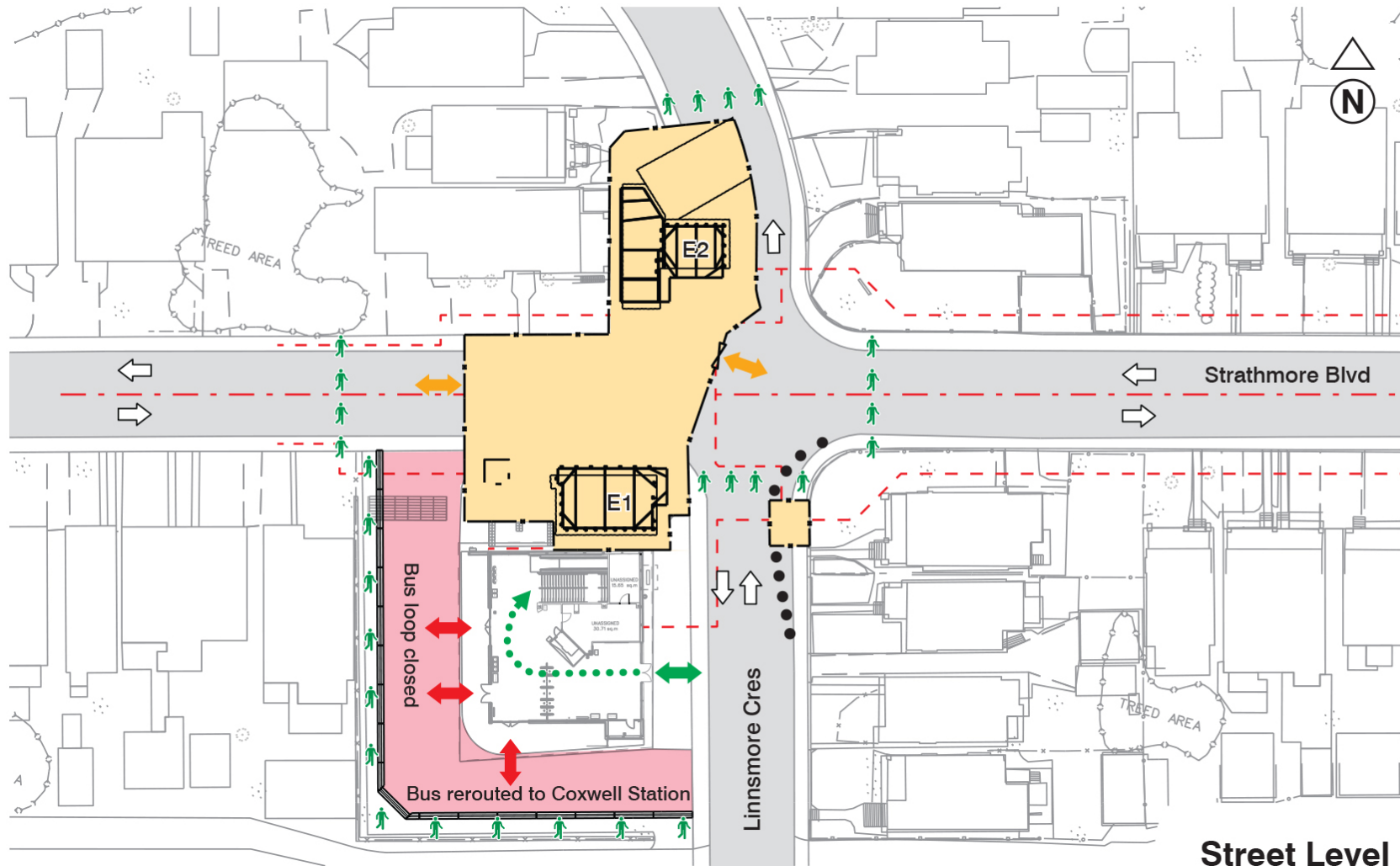

Legends

- · — Hoarding
- Construction area
- - - Station outline
- Station entrance
- Bus station exit
- Emergency exit
- Construction entrance
- Pedestrian flow
- Direction of traffic
- Pedestrian crossing

Street Level

Plans are subject to change

Conceptual Staging - Phase 4 (Phase 3 & 4 combined approx. 15 months)

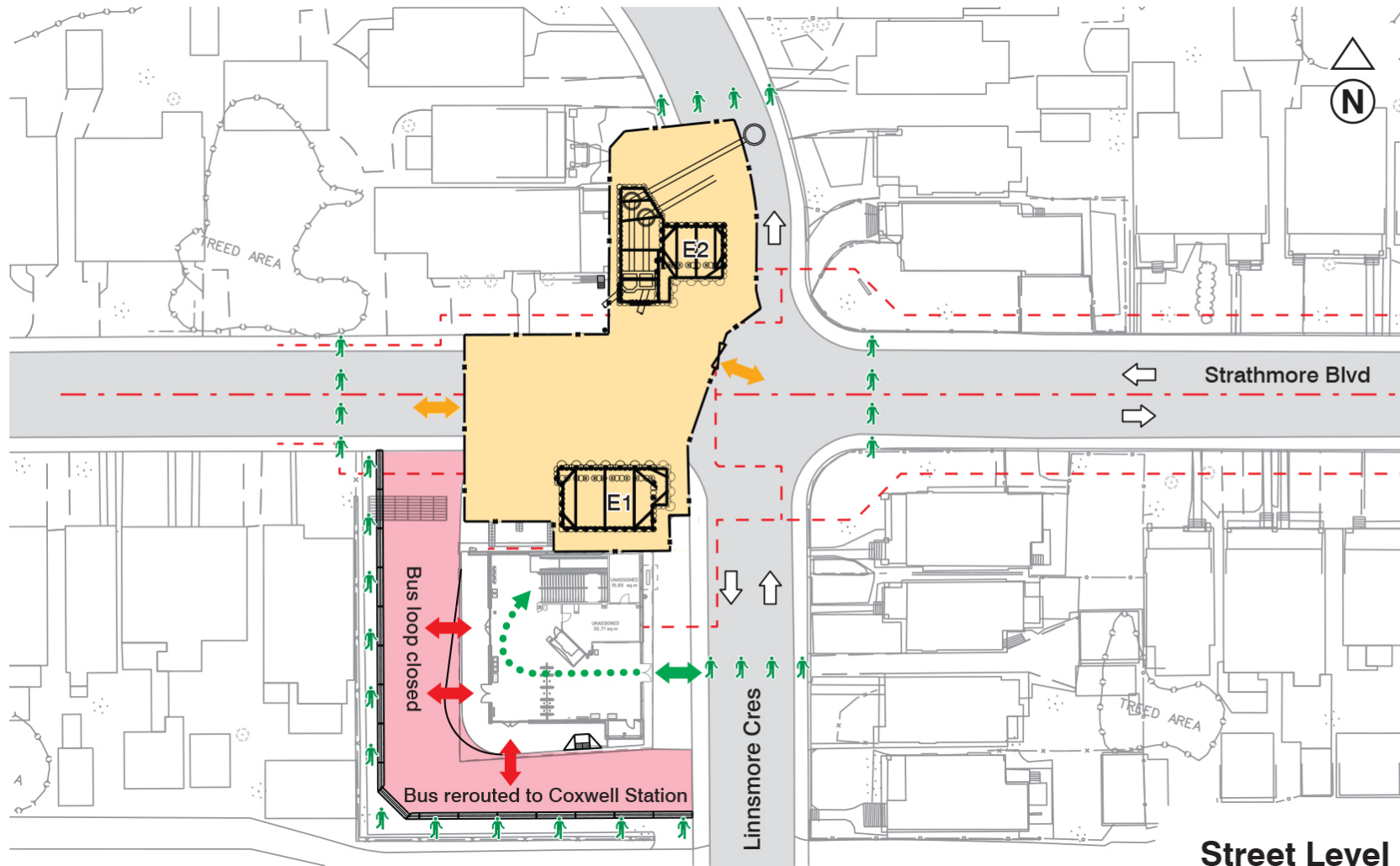

Legends

- · — Hoarding
- Construction area
- - - Station outline
- Station entrance
- Bus station exit
- Emergency exit
- Construction entrance
- Pedestrian flow
- Direction of traffic
- Pedestrian crossing

Street Level

Plans are subject to change

Conceptual Staging - Phase 5 (Phase 5 & 6 combined for approx. 8 months)

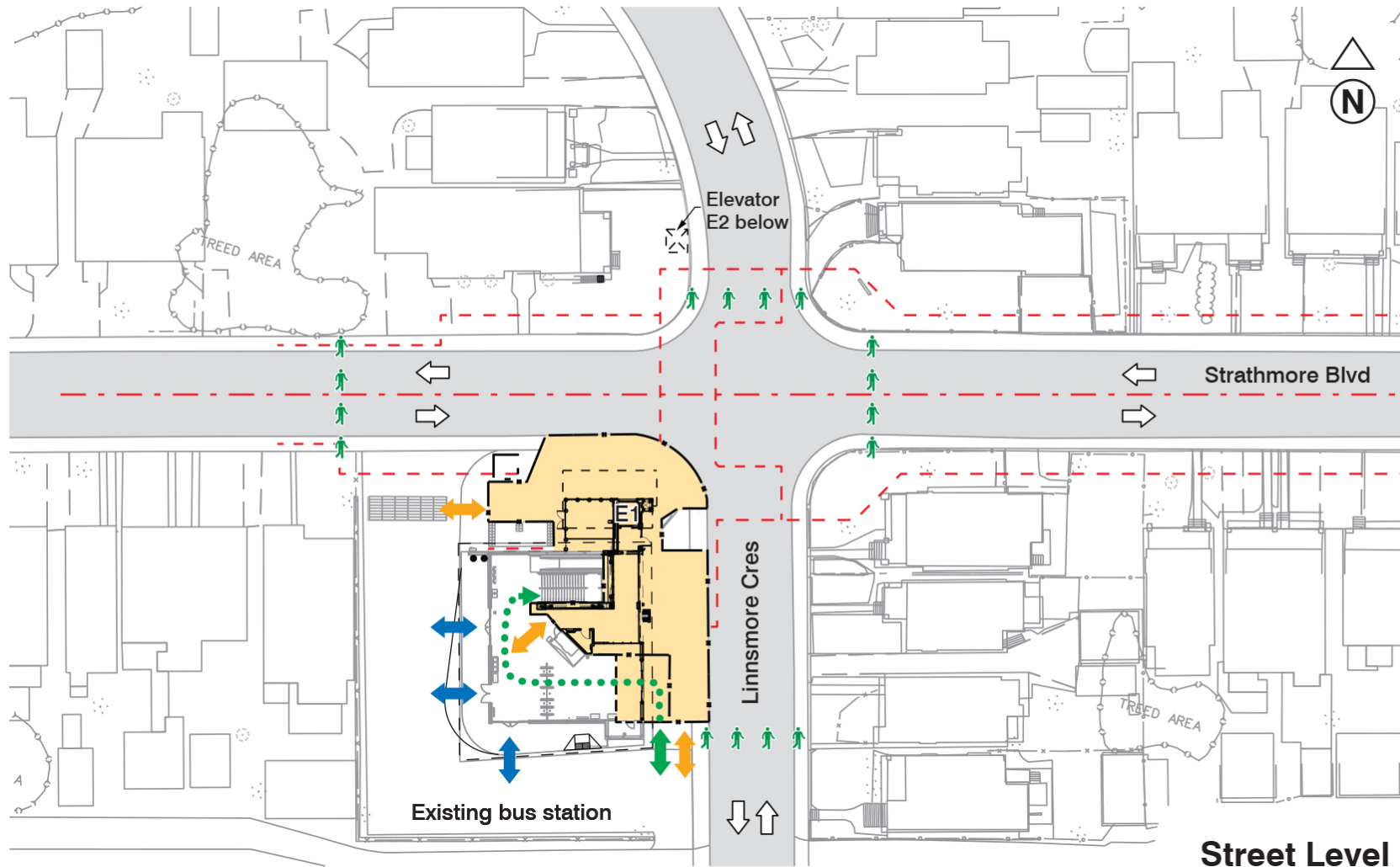

Legends

- · — Hoarding
- Construction area
- - - Station outline
- Station entrance
- Bus station exit
- Emergency exit
- Construction entrance
- Pedestrian flow
- Direction of traffic
- Pedestrian crossing

Plans are subject to change

Conceptual Staging - Phase 6 (Phase 5 & 6 combined for approx. 8 months)

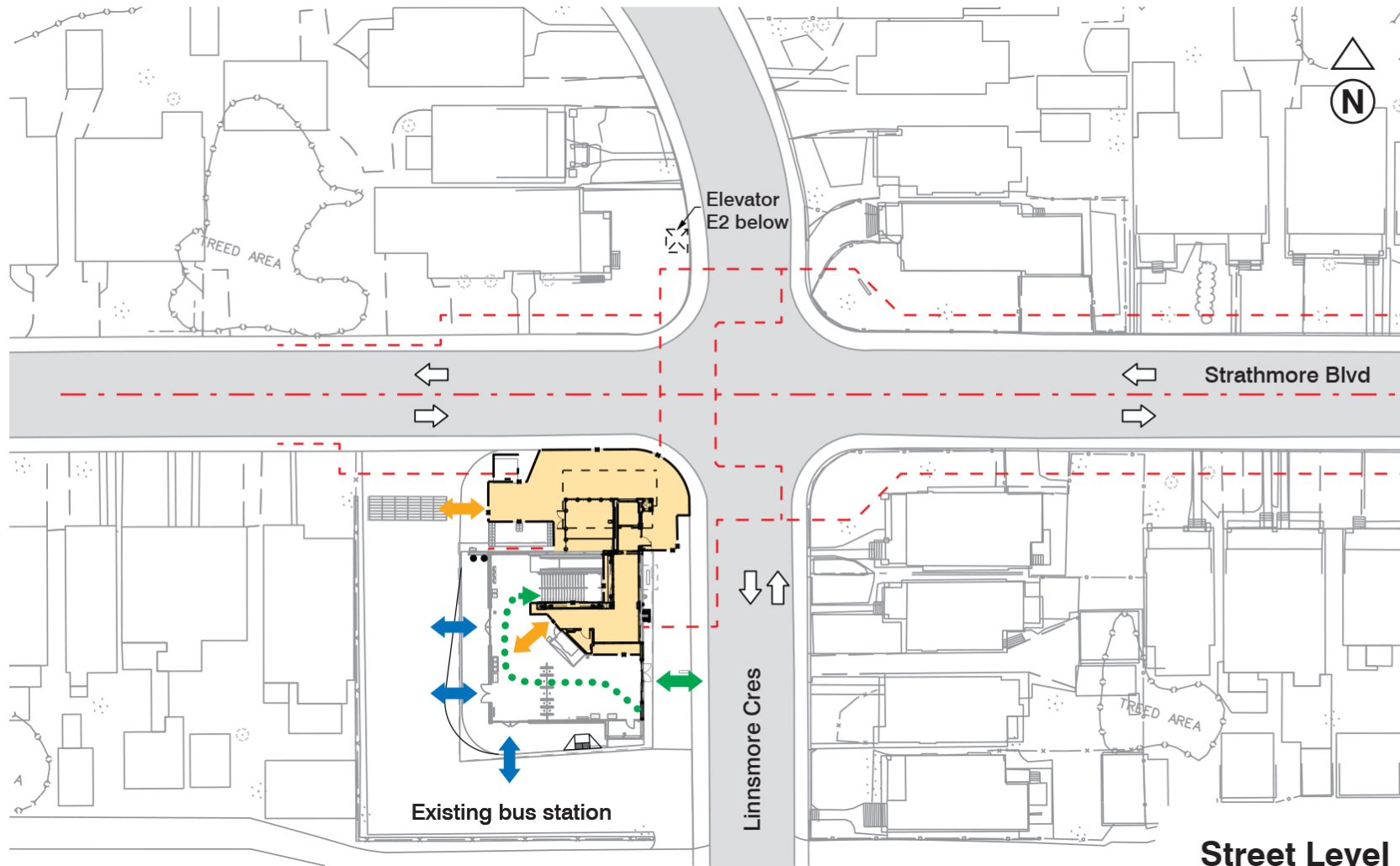

Legends

- · — Hoarding
- Construction area
- - - Station outline
- Station entrance
- Bus station exit
- Emergency exit
- Construction entrance
- Pedestrian flow
- Direction of traffic

Street Level

Plans are subject to change

| Strathmore & Linnsmore – Parking Impacts

- Available street parking will be reduced in the area of construction. If residents already have a street parking permit they may park on any licenced street within their permit area. Please see a map of the parking permit area here: [Permit parking area map of areas waitlisted or approaching capacity](#).
- TTC has reached out to City of Toronto Transportation Services to create new temporary parking in the area during construction, where possible.

| Transit Service and Traffic Impacts

- Access to the station will be maintained throughout construction.
- No impacts to subway service on Line 2 – Bloor Danforth.
- During some stages, pedestrian detours will be in place and traffic lanes may be closed or reduced.
- **In order to accommodate excavation, caissons and building the underground structure, traffic lanes at Strathmore and Linnsmore intersection will be affected:**
 - (Strathmore, west of Linnsmore) eastbound lane closed for traffic in Phase 1
 - (Linnsmore, north of Strathmore) will be closed in Phase 2
 - (Linnsmore, north of Strathmore) southbound lane will be closed during phases 3 & 4 (northbound lane is now opened)
 - (Linnsmore, south of Strathmore) reduced lanes during a partial duration of Phase 3
 - (Strathmore at Linnsmore) closed in Phases 3 & 4

Transit Service and Traffic Impacts Continued

Greenwood Station Bus Loop Closure

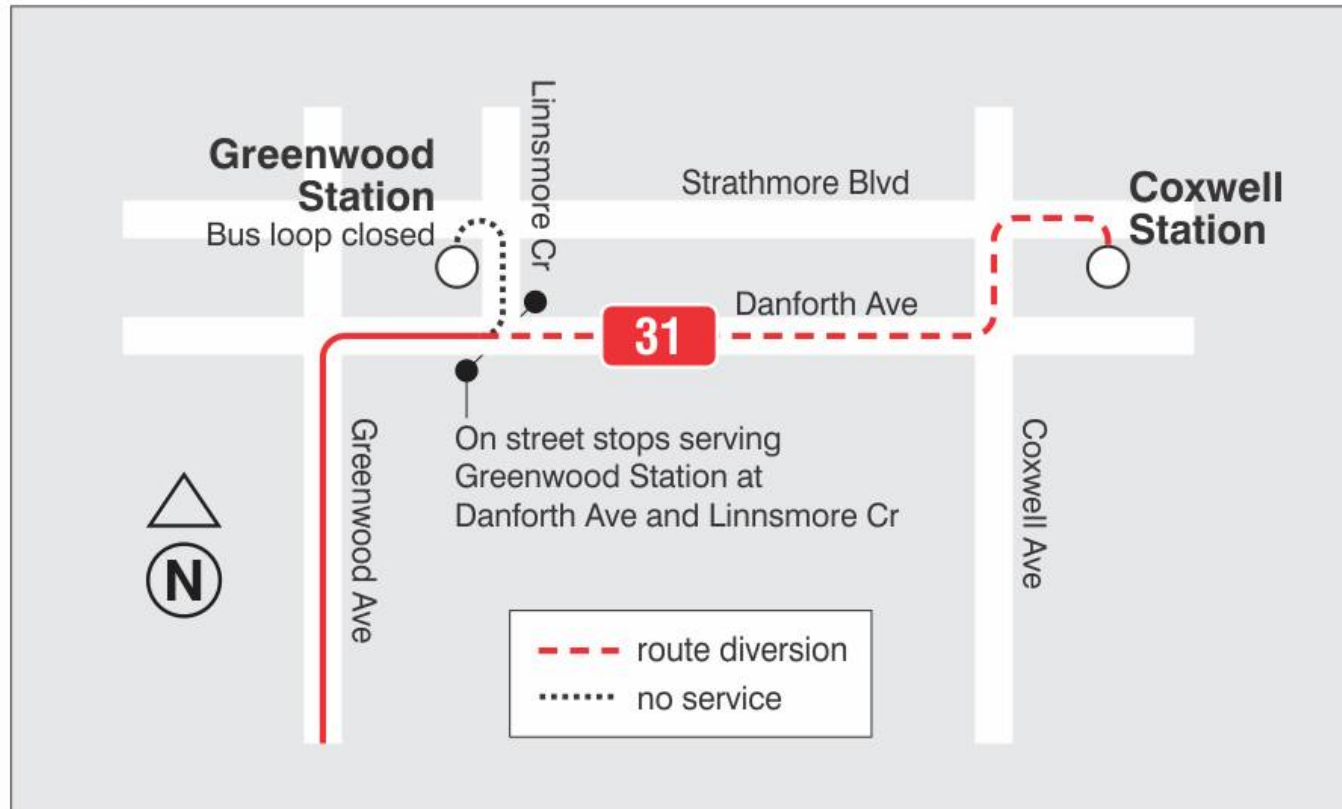

- During the closure of the bus loop at Greenwood Station, the 31 Greenwood buses will divert to Coxwell Station via Danforth Avenue and Coxwell Avenue in all service periods.
- Regular service levels will be maintained.
- Customers can access Greenwood Station from bus stops on Danforth Avenue at Linnsmore Crescent.

| Construction

- The majority of work will take place between 7 a.m. and 7 p.m., as required.
- As permitted, some overnight and weekend work will be required during the course of this project in order to complete the work as quickly as possible.
- Noise, dust and vibration associated with construction is unavoidable with this work.
- Mitigation measures such as vibration monitoring, and wet cutting of concrete and mesh fencing (to reduce dust) will be implemented.
- Construction trucks, equipment and workers will be present in the general area.
- Bike parking to be temporarily removed or relocated if possible. The existing bike share at the station will have to be removed.
- TTC Community Liaison will provide construction updates, coordinate responses to questions, coordinate meetings with neighbours and the project team.



| Other local Bike Share station (on Lamb Ave.)



| The Danforth and local businesses

- While the project benefits the community in the long-term, we understand that construction can be disruptive and are pleased to work with the BIA and local businesses to convey the message that businesses are open during construction.
- Please note that this project does not take place on the Danforth.
- The laneway will remain open and available. The laneway itself is under the City's jurisdiction. Please call 311 for any laneway concerns related to traffic, encroachment, maintenance and salting/snow removal.
- Area waste collection conducted by the City will continue as per their schedule.

| Greenwood Station public art

- Greenwood Station will receive public art in accordance with the TTC Public Art Policy.
- An open call and pre-qualification will be issued; three artists will be selected per station to create and present an art concept.
- A jury from the Arts community will be formed including a member with ties to the neighbourhood.
- Art will be installed at a later date (TBD).

